

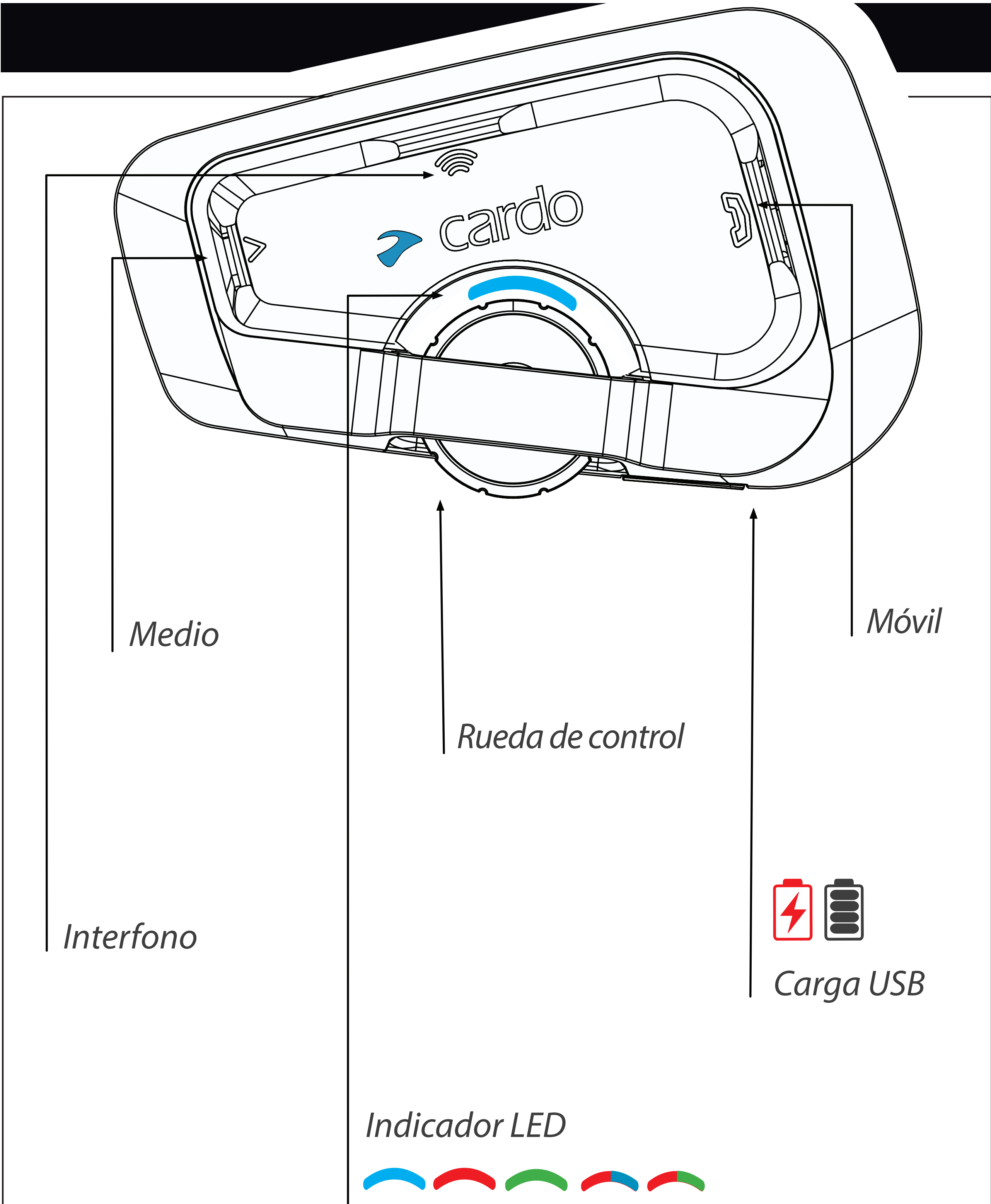

CARDO
FREECOM 4x

.....
GUÍA DE BOLSILLO
ES





Mantener pulsado el botón



Número de pulsaciones

Guía de inicio

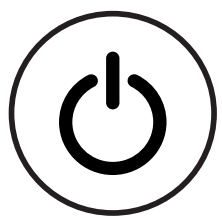

Encendido/Apagado

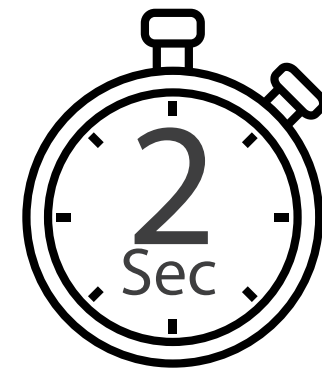
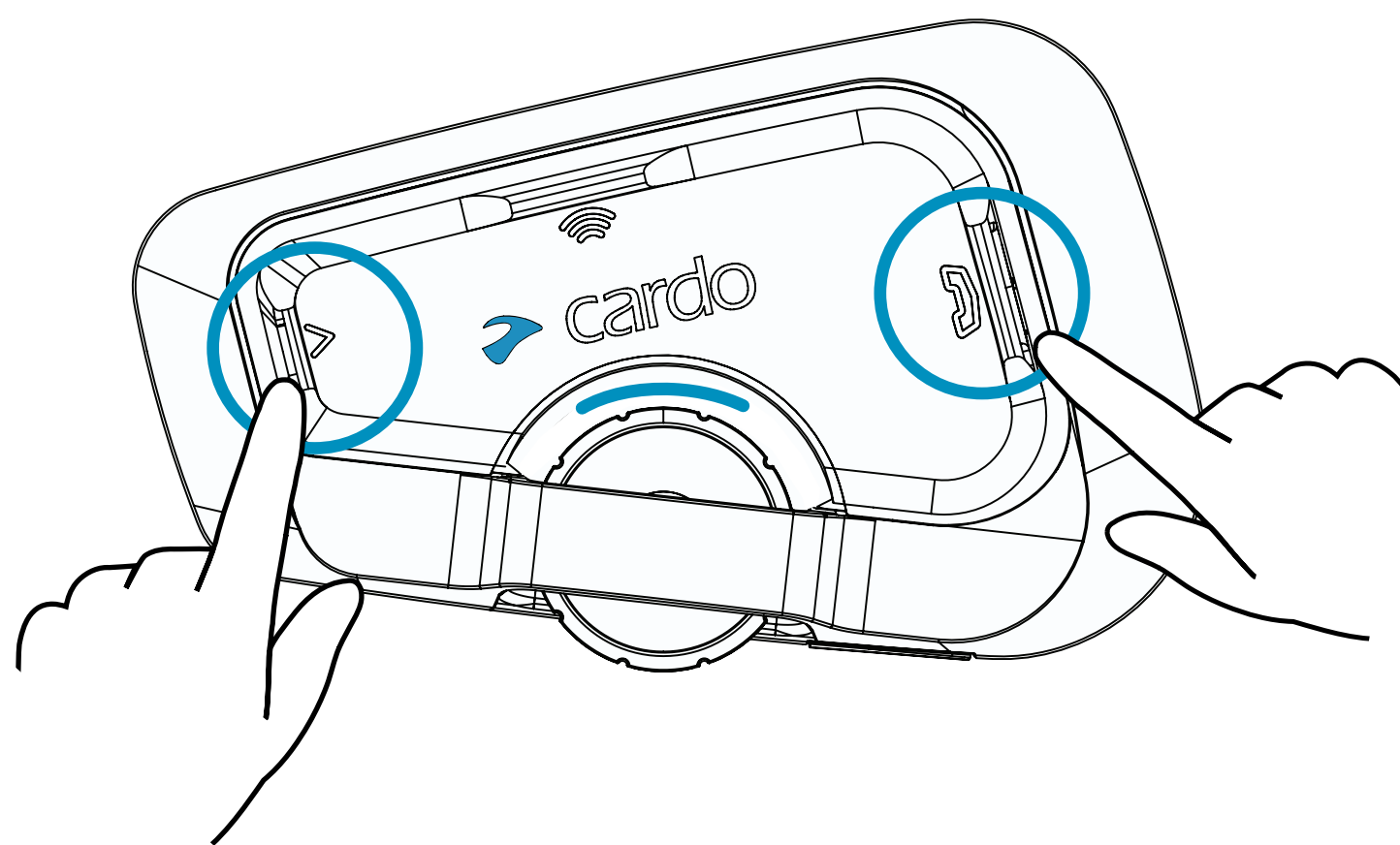

Vincular teléfono

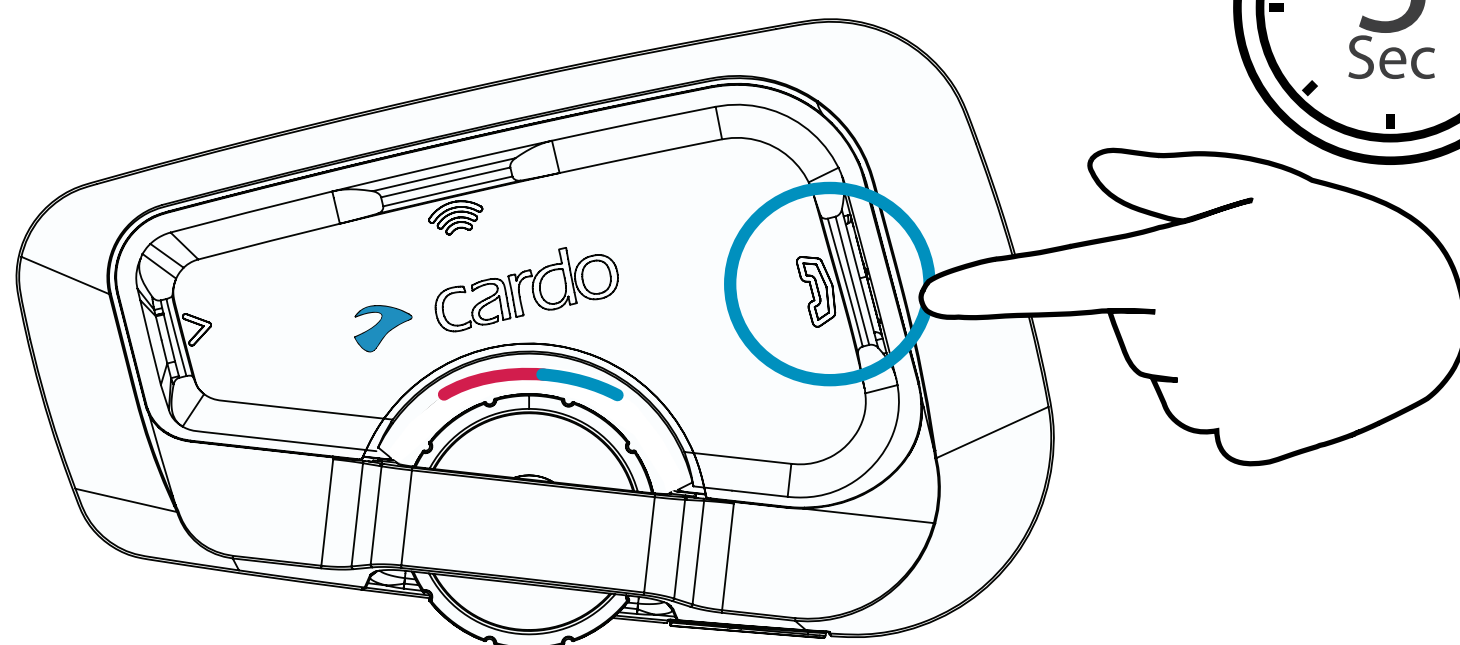

Ledes en rojo y azul 



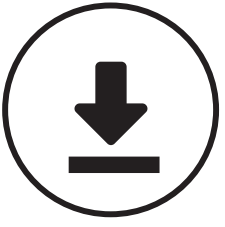

Descargar



Registrar

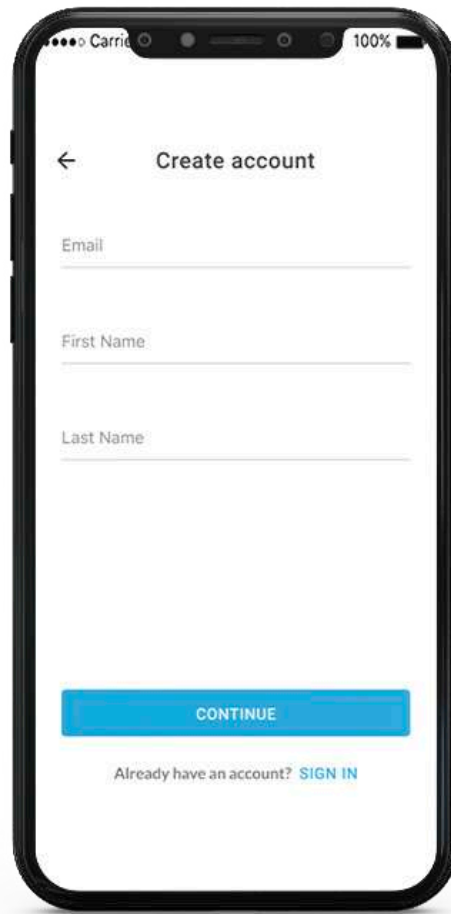

Seleccionar idioma

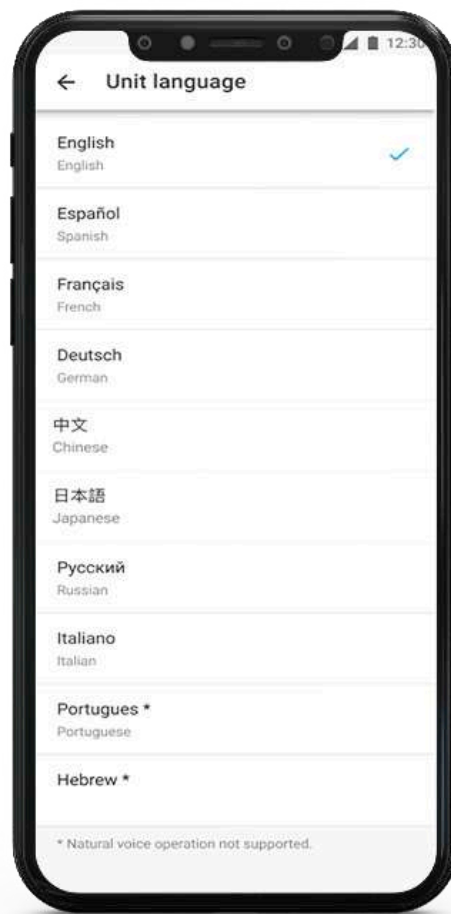

Actualizar software

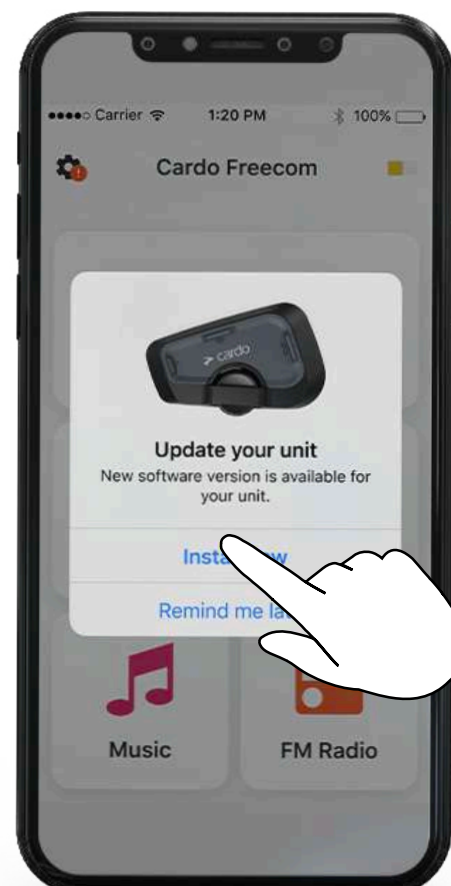

General

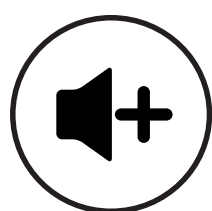

Subir volumen

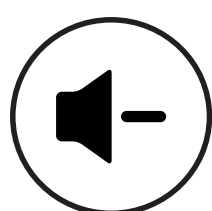
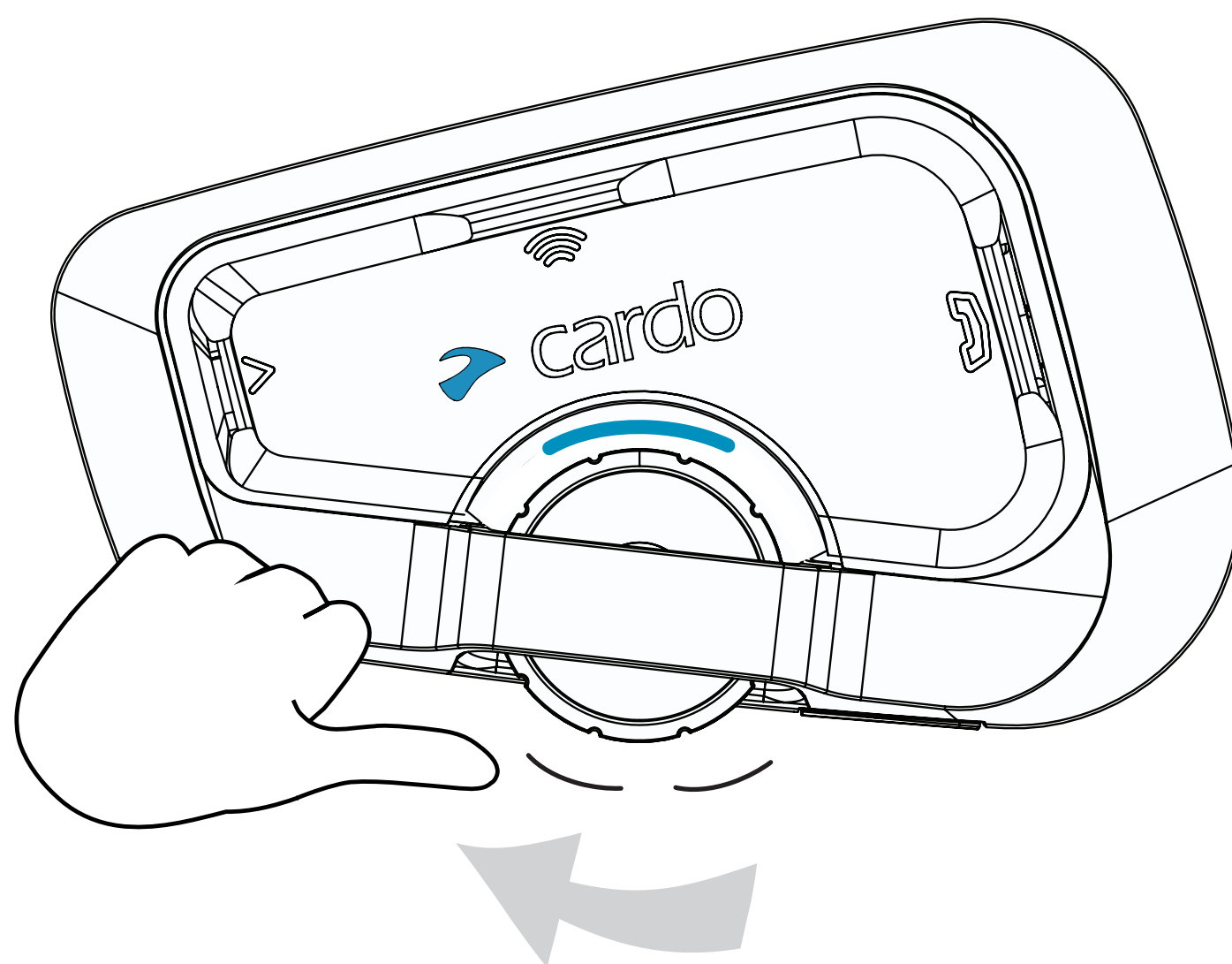

Bajar volumen

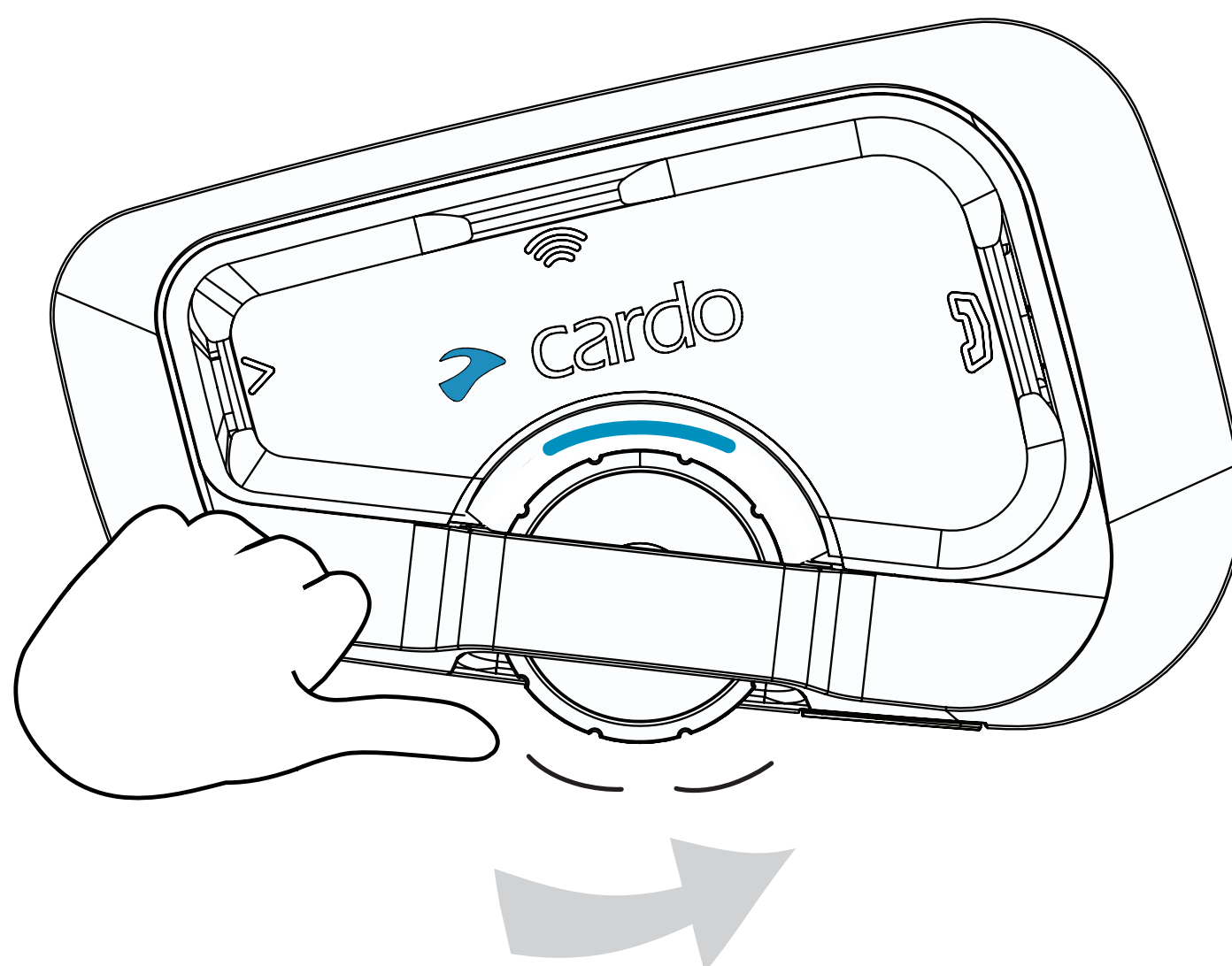

Asistente de voz

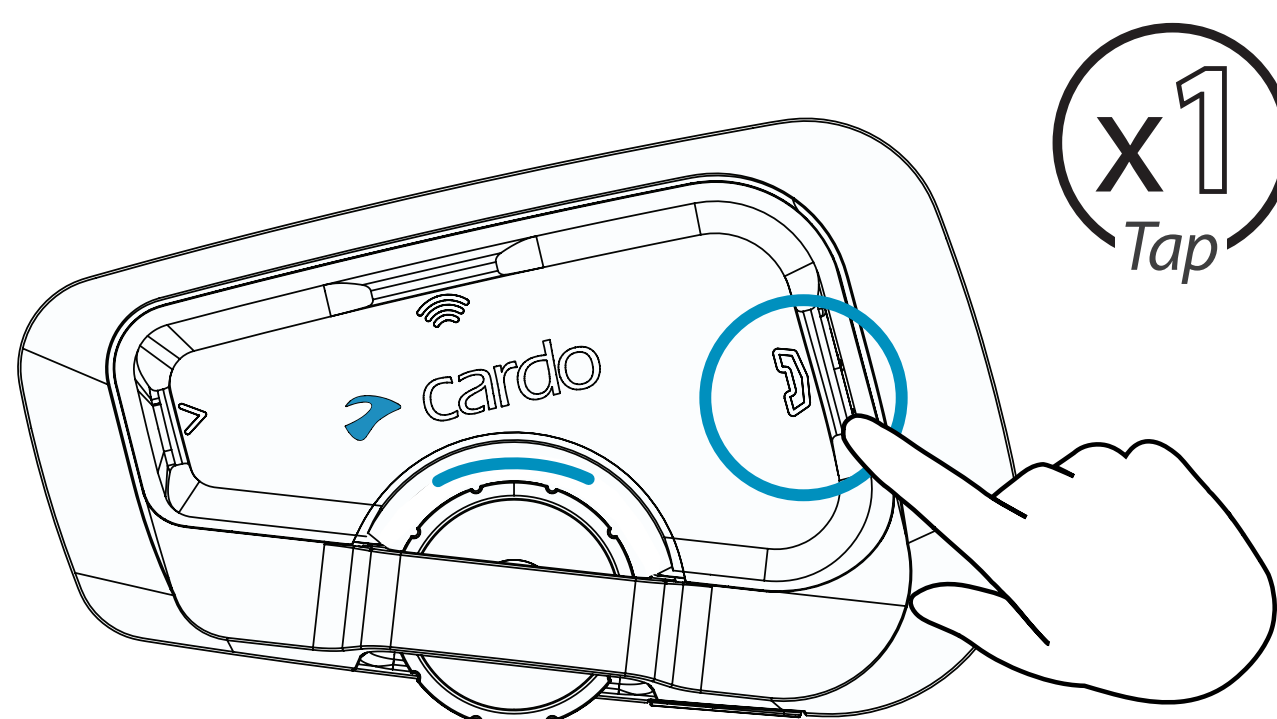

Música



Reproducir

x1
Tap

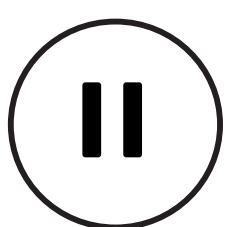
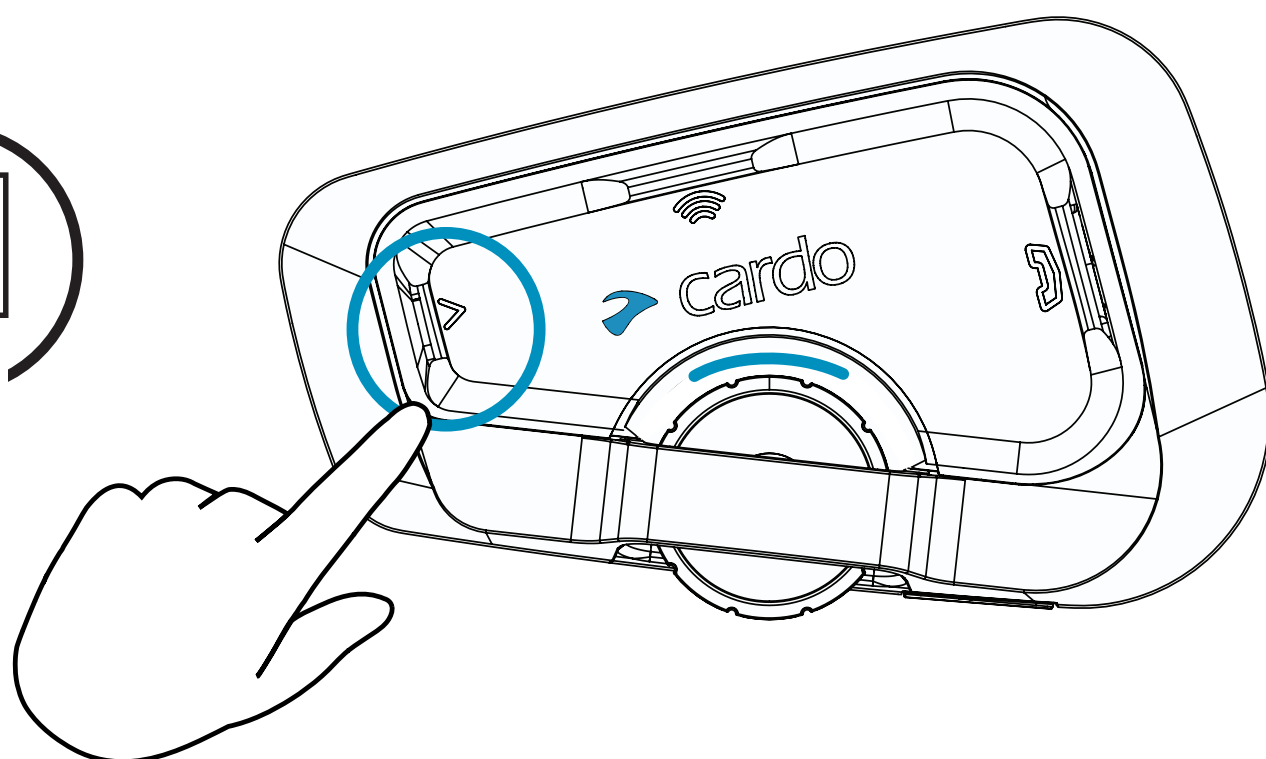

Pausar

x1
Tap

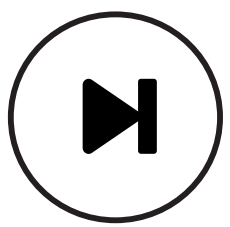
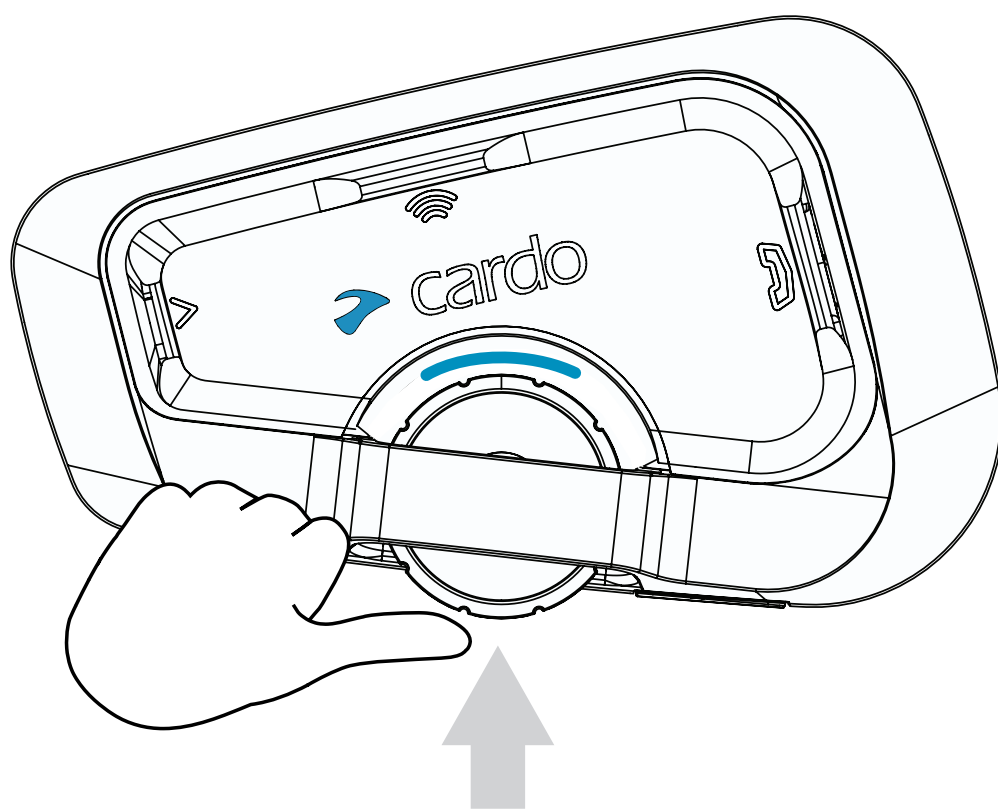

Siguiente

x1
Tap

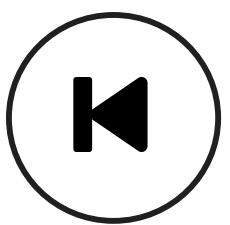
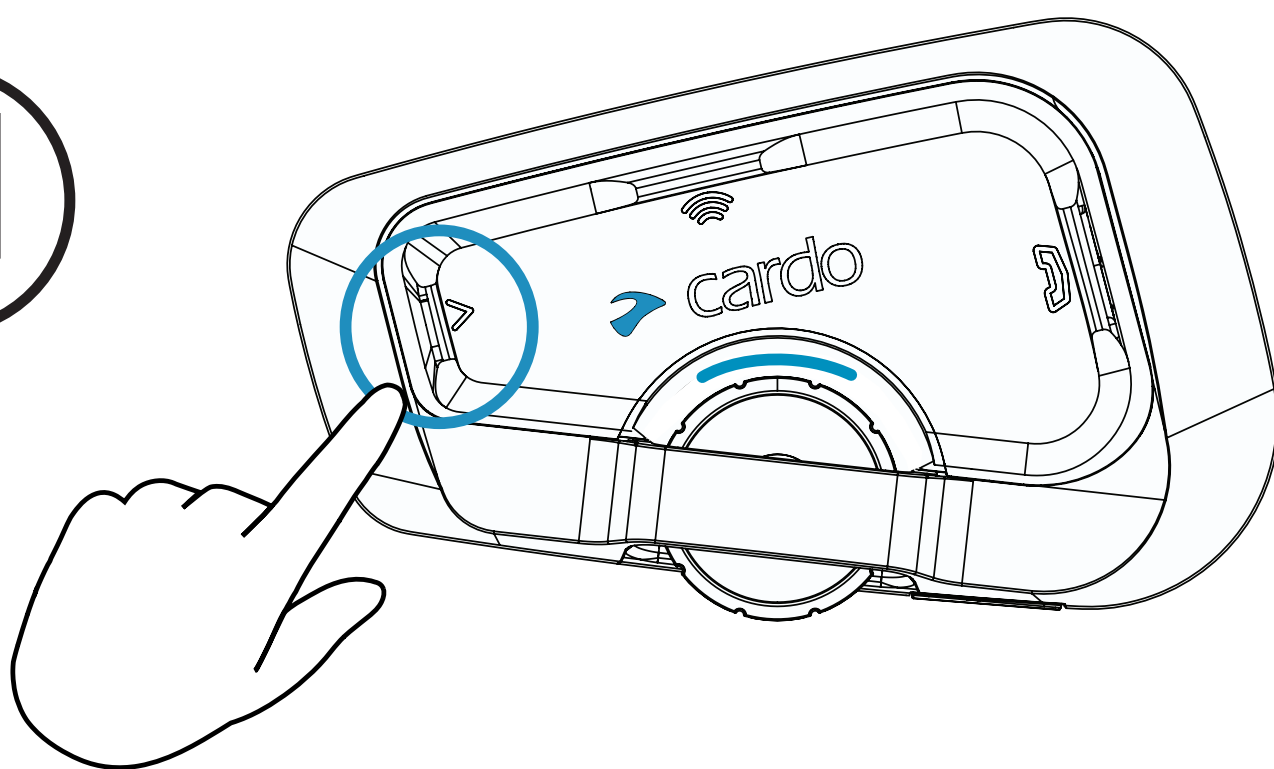

Anterior

x2
Tap

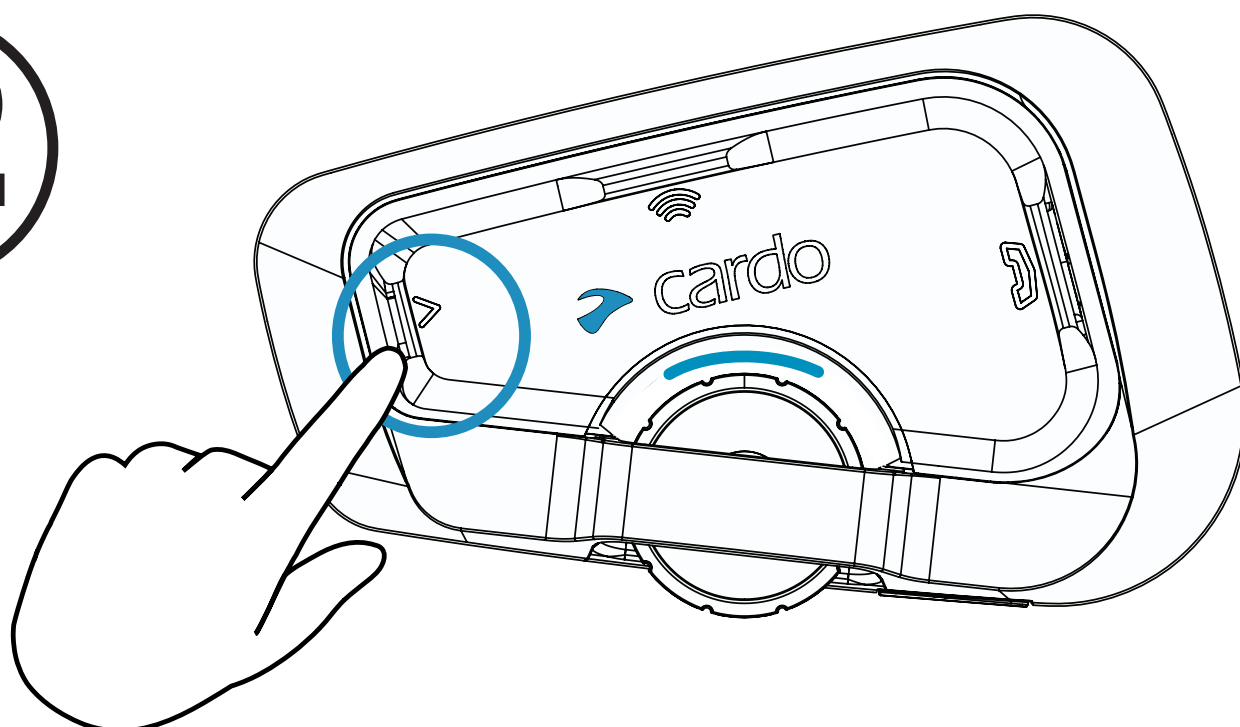

Radio



Establecer preajustes

1

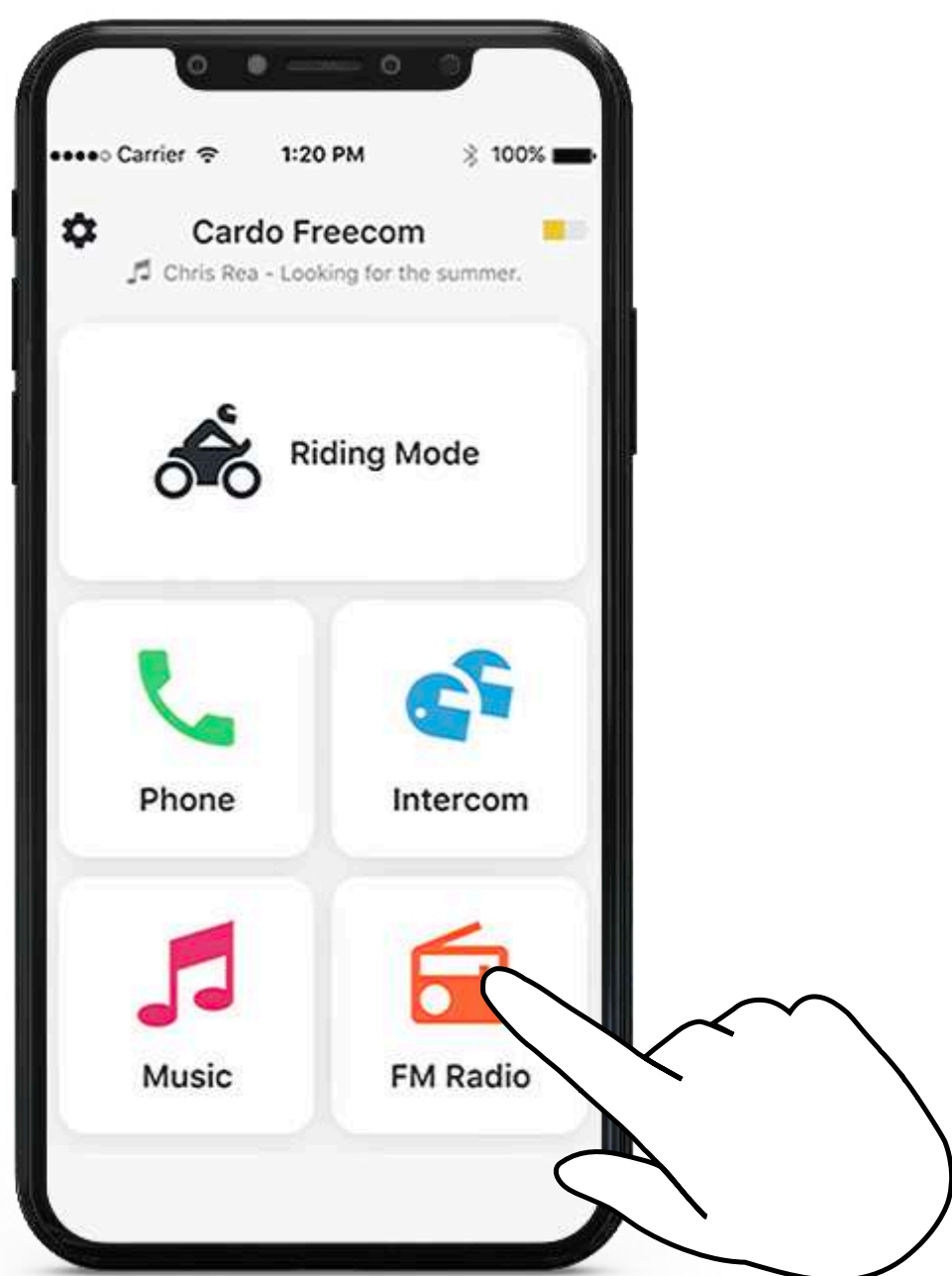

2

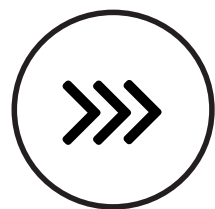

Iniciar exploración

X3
Tap

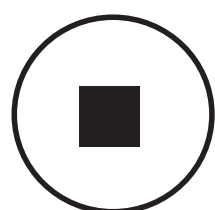
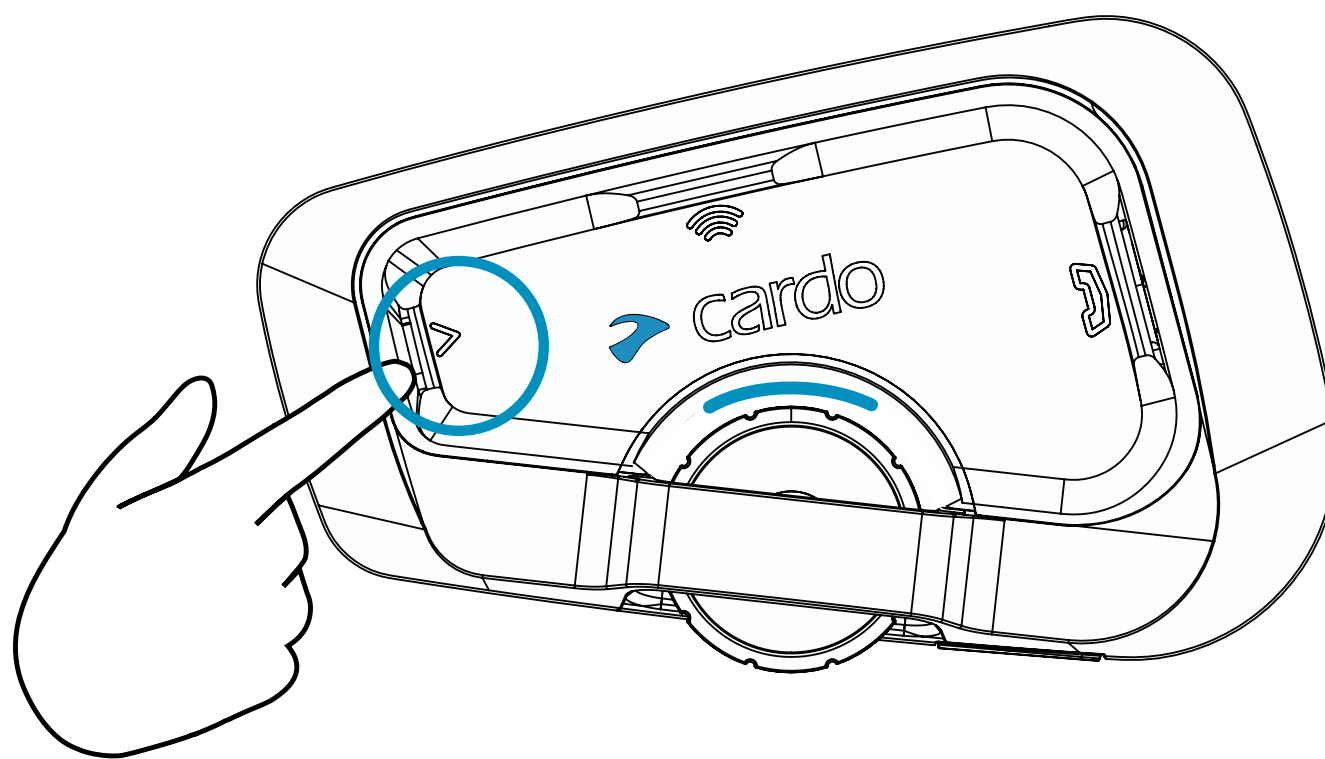

Detener exploración

X1
Tap

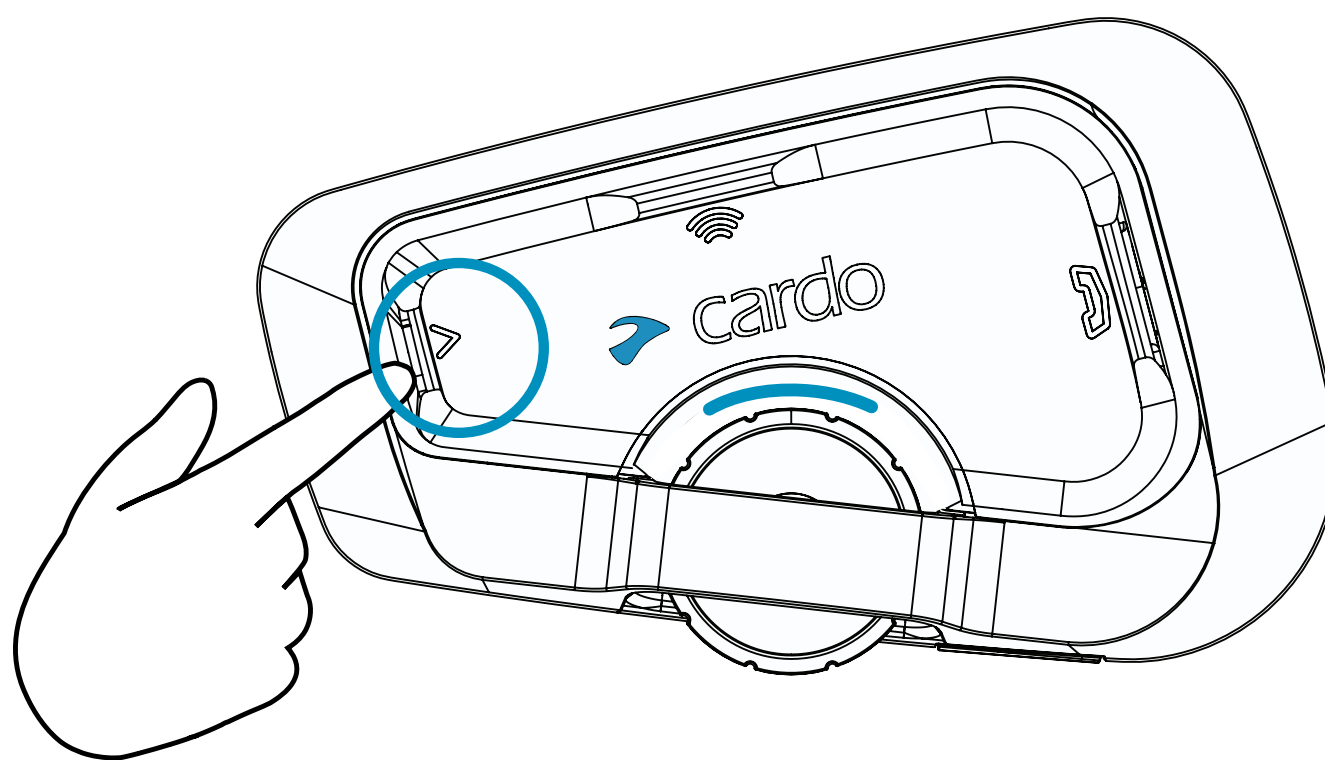

Radio



Encender

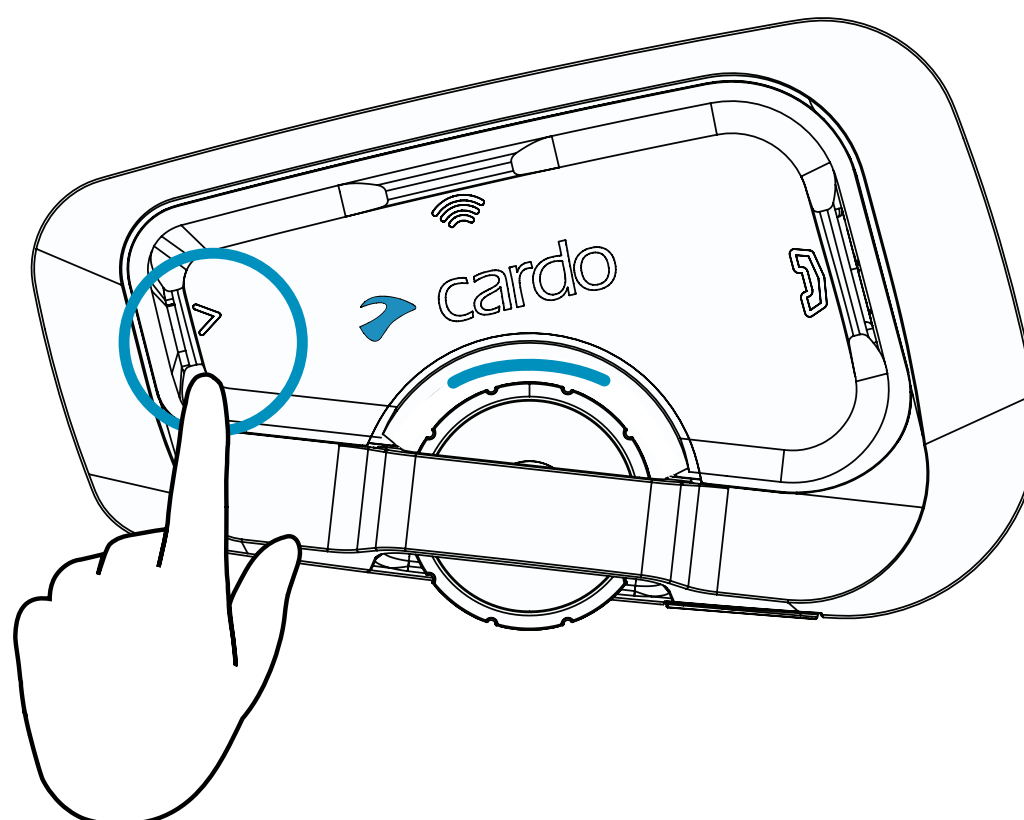

Apagar

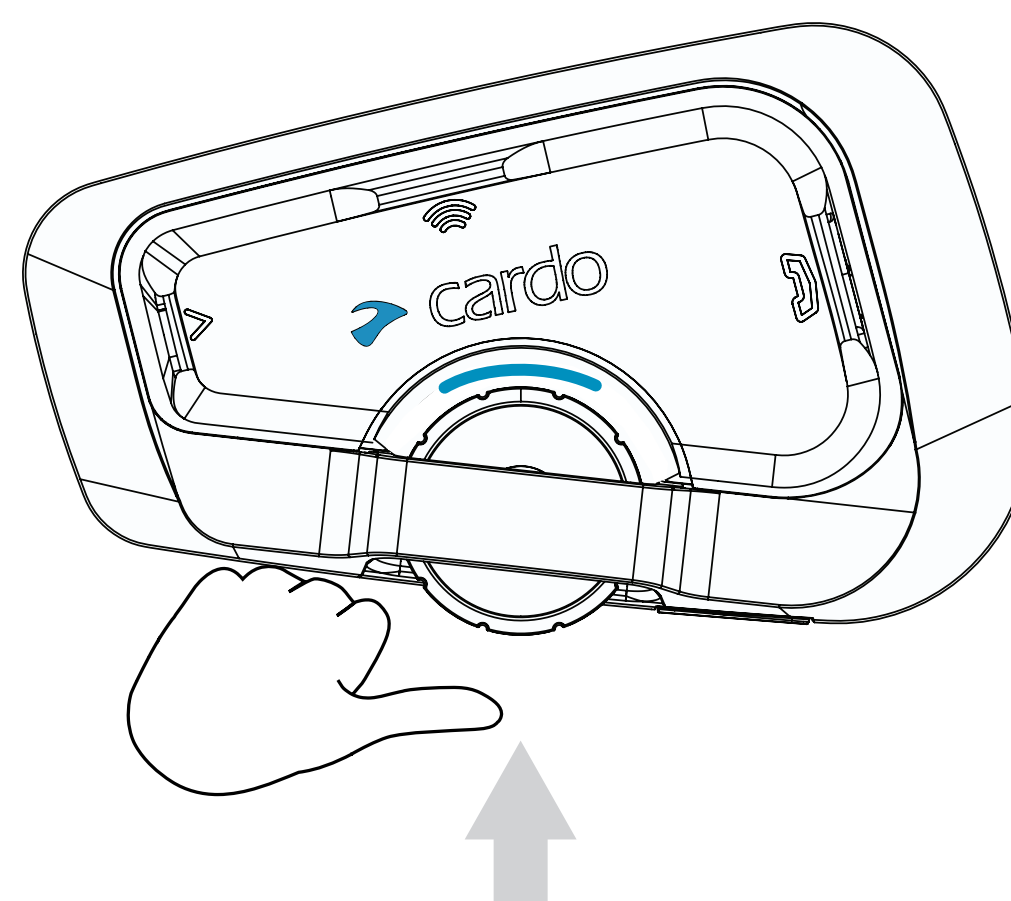

Siguiente preselección

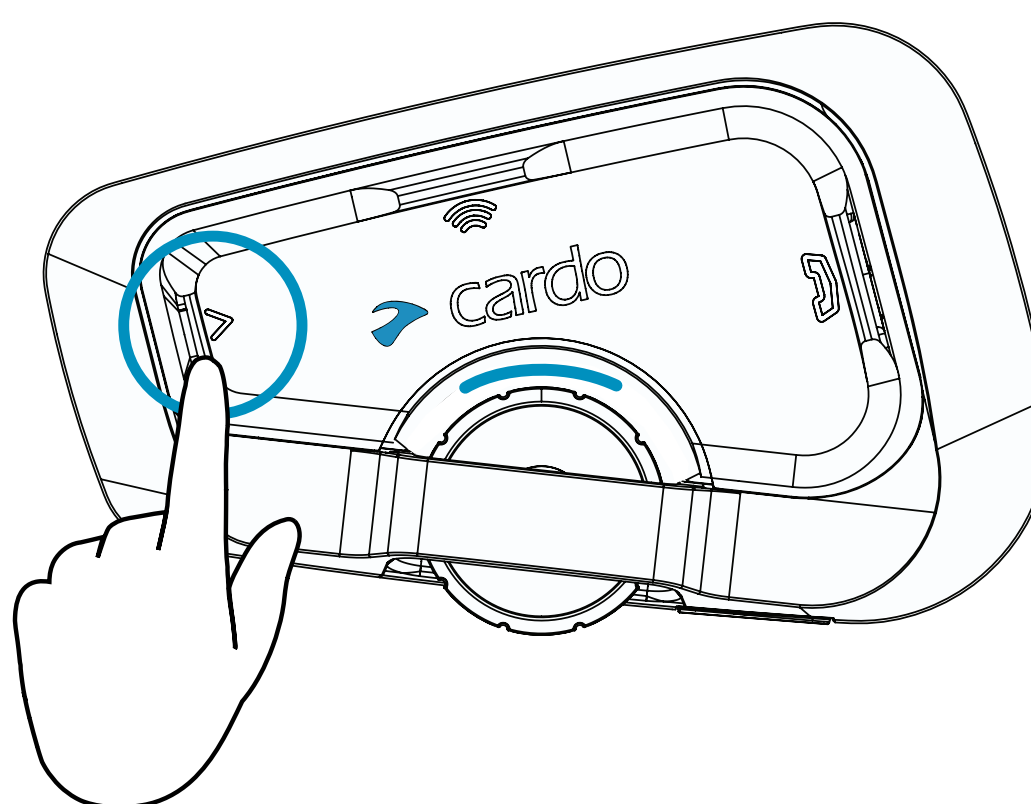

Anterior preselección

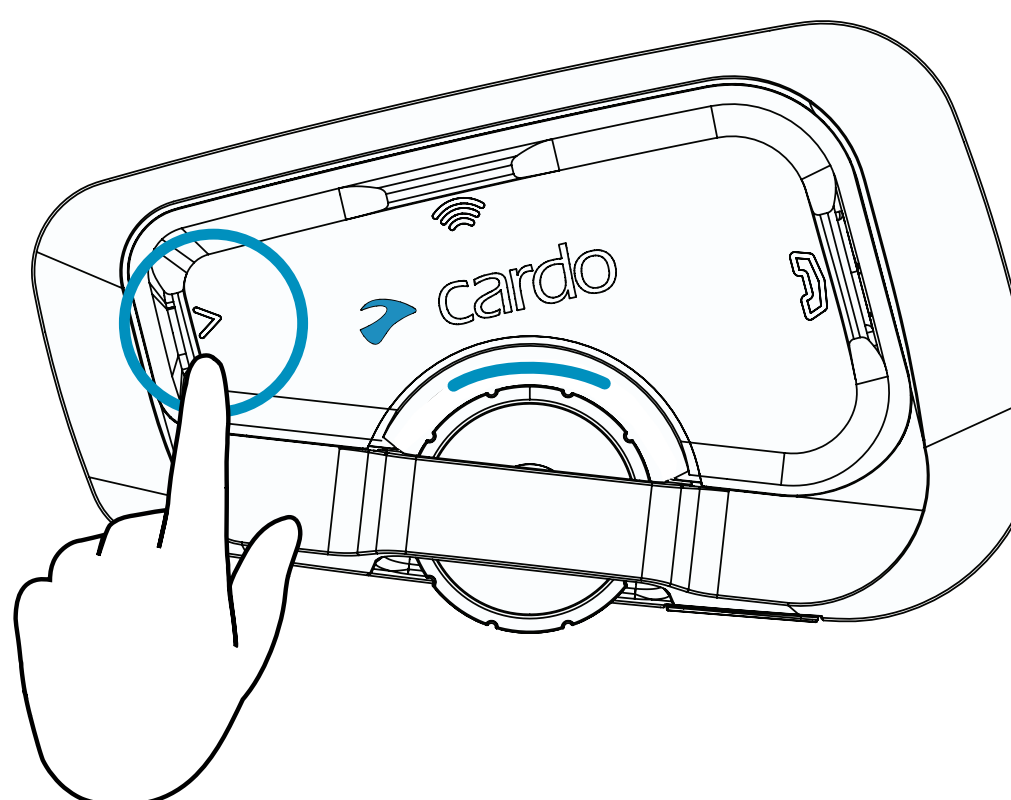

Cambiar fuente



Música a radio

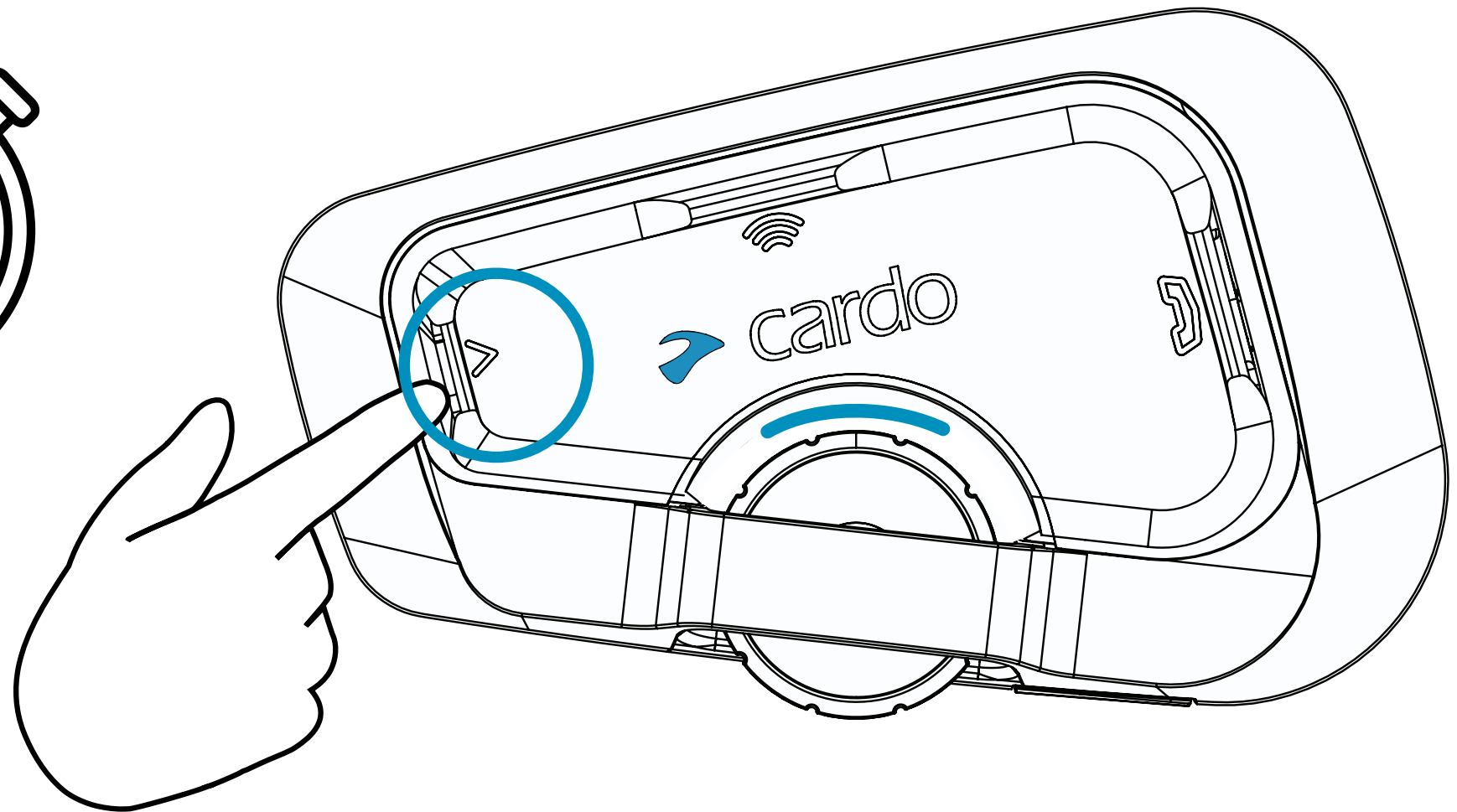

Radio a música

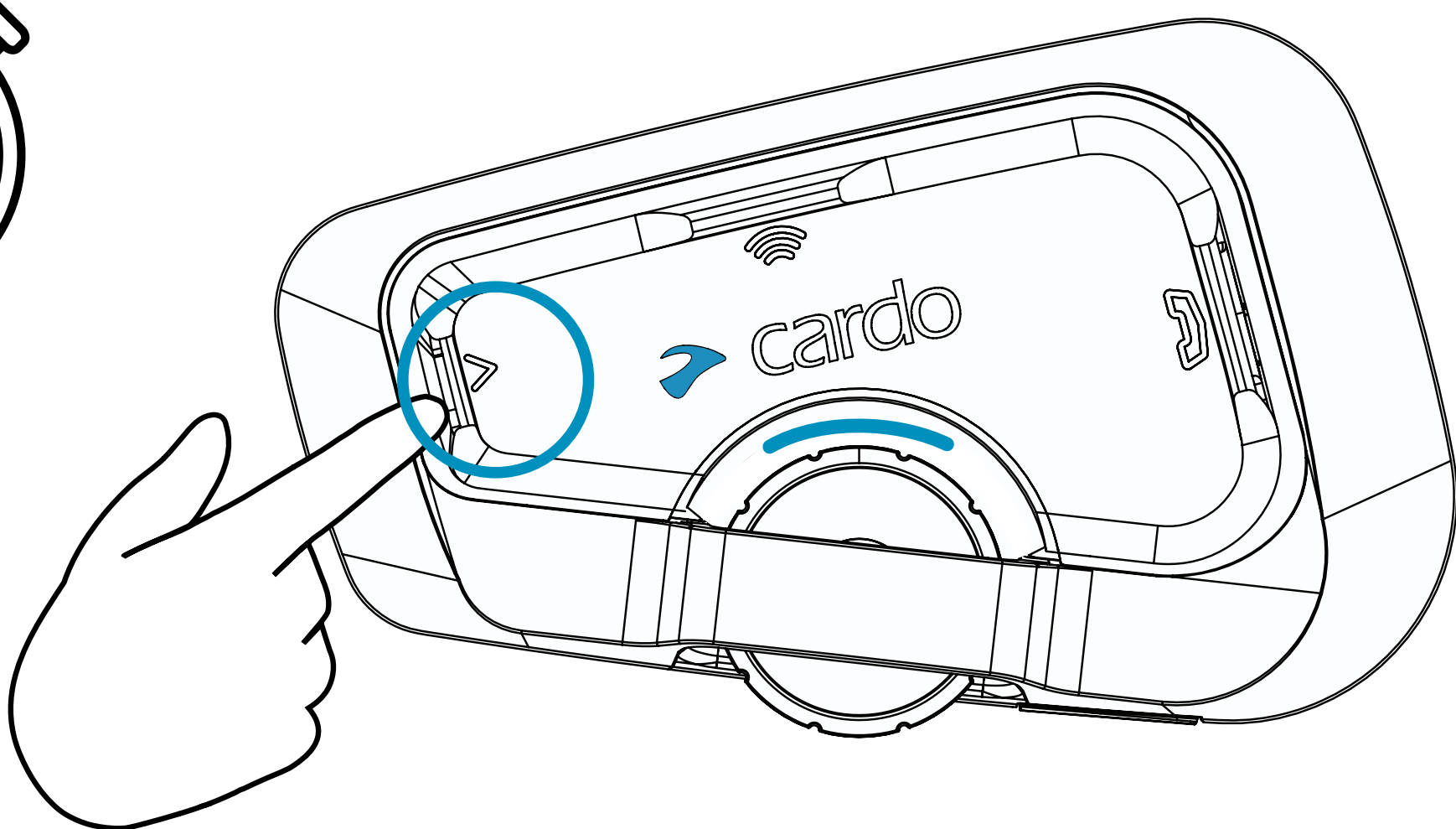
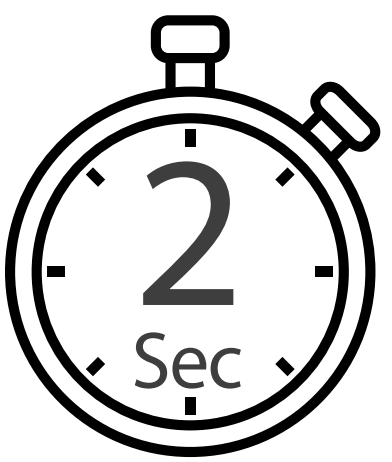

Llamada telefónica



Contestar

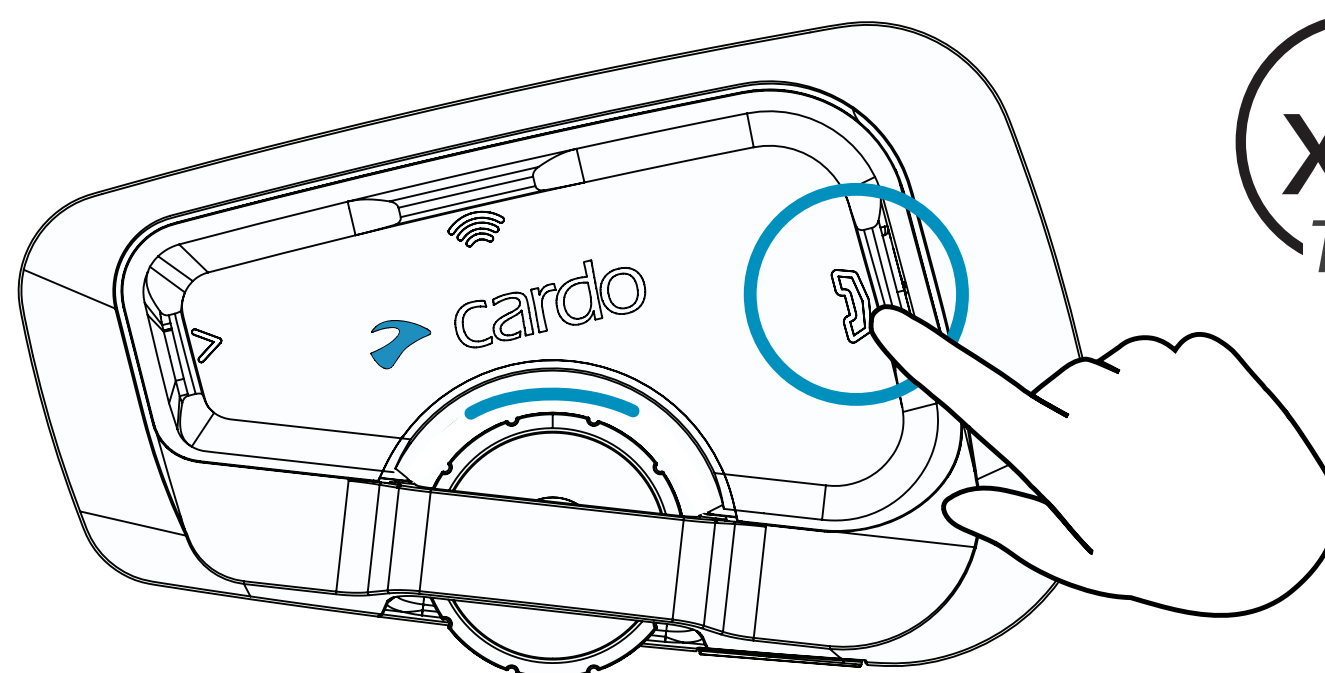

Ignorar

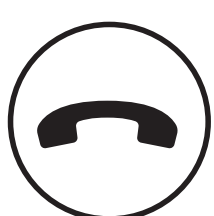
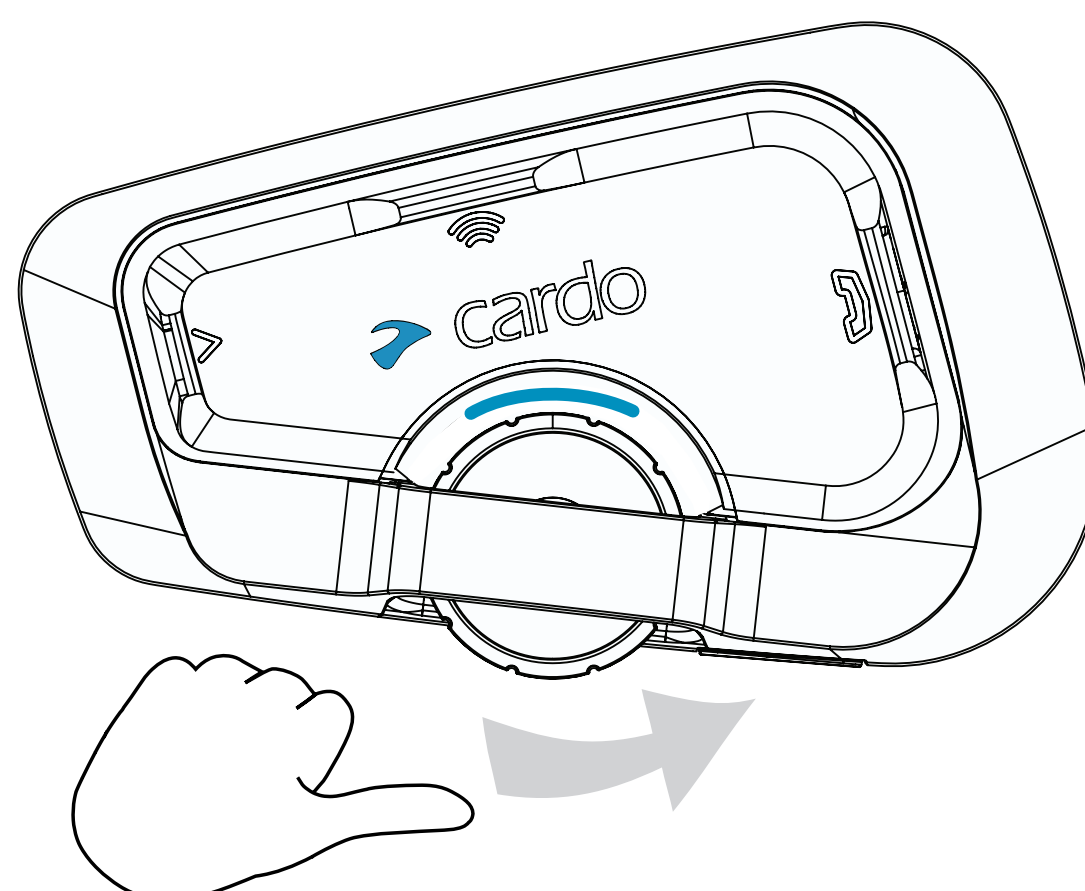

Finalizar llamada

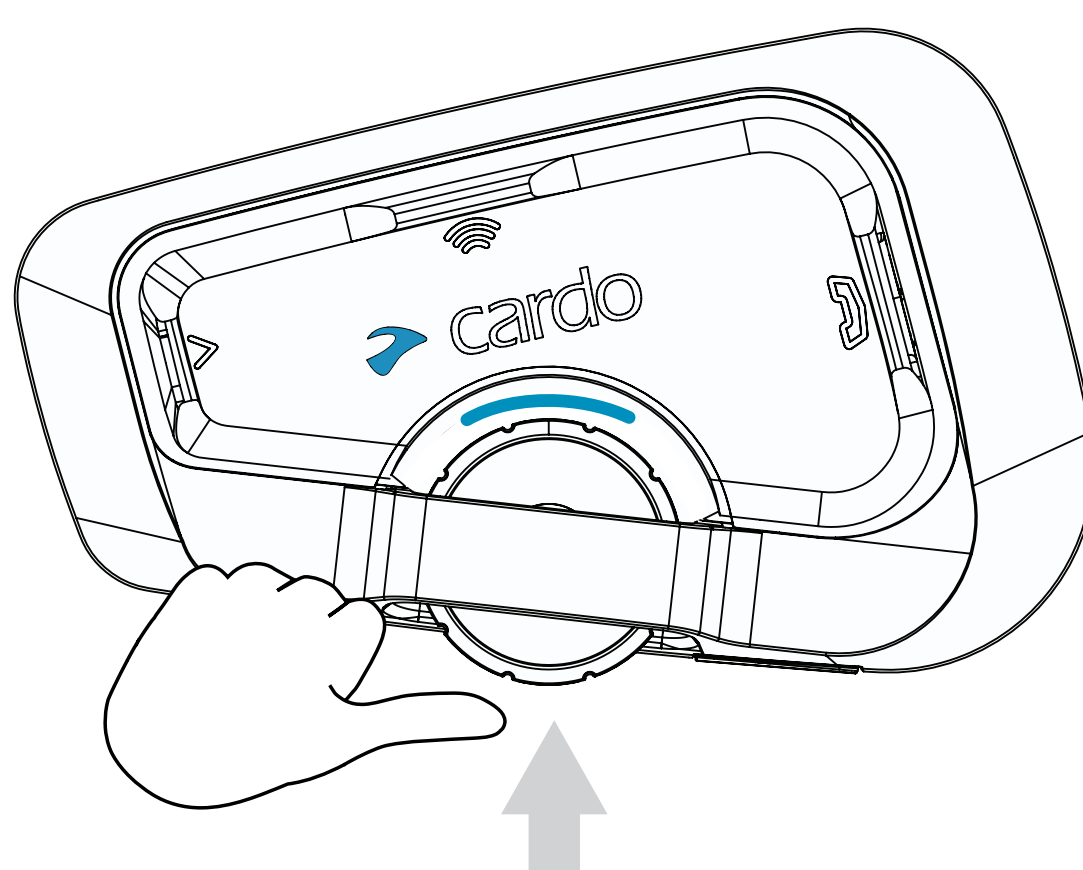

Rellamada

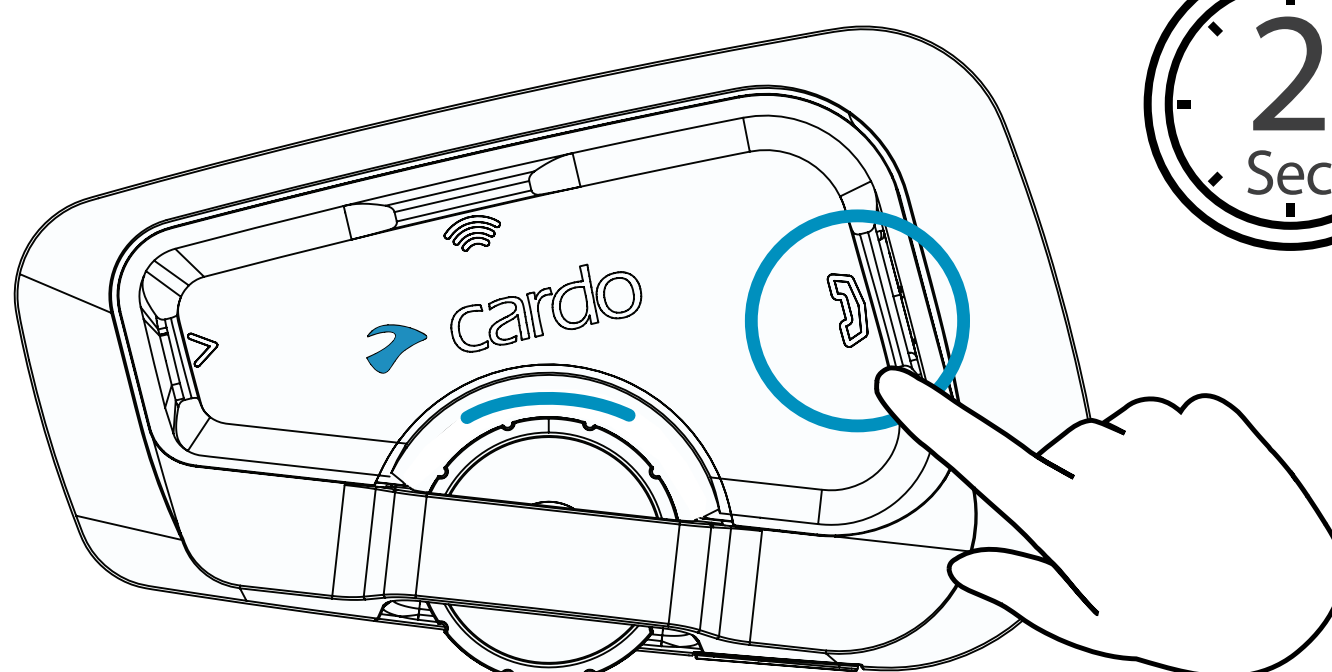

Llamada telefónica



Marcación rápida

Seleccionar número

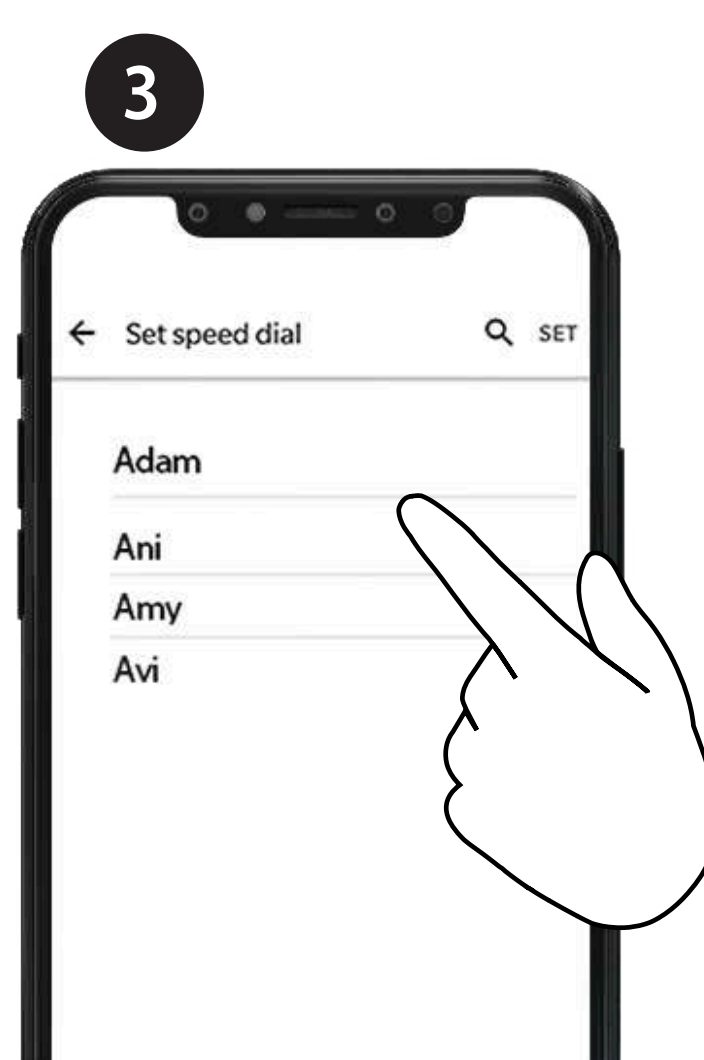
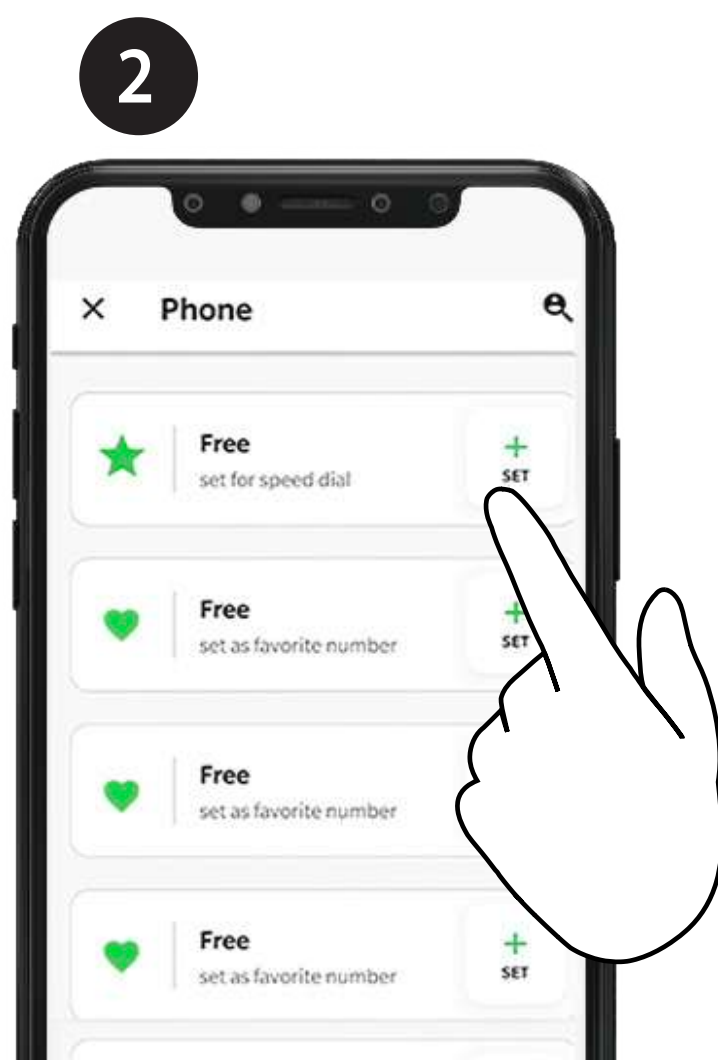
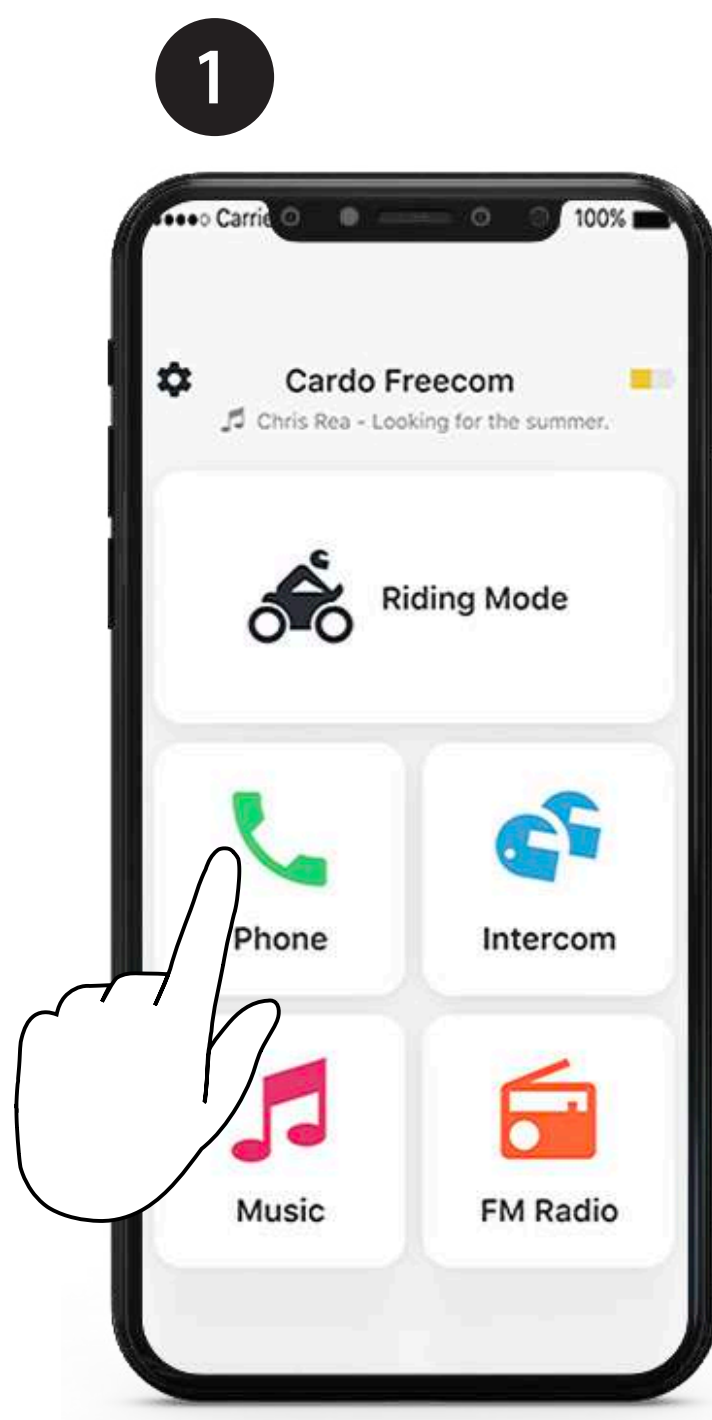

Marcación rápida de llamada

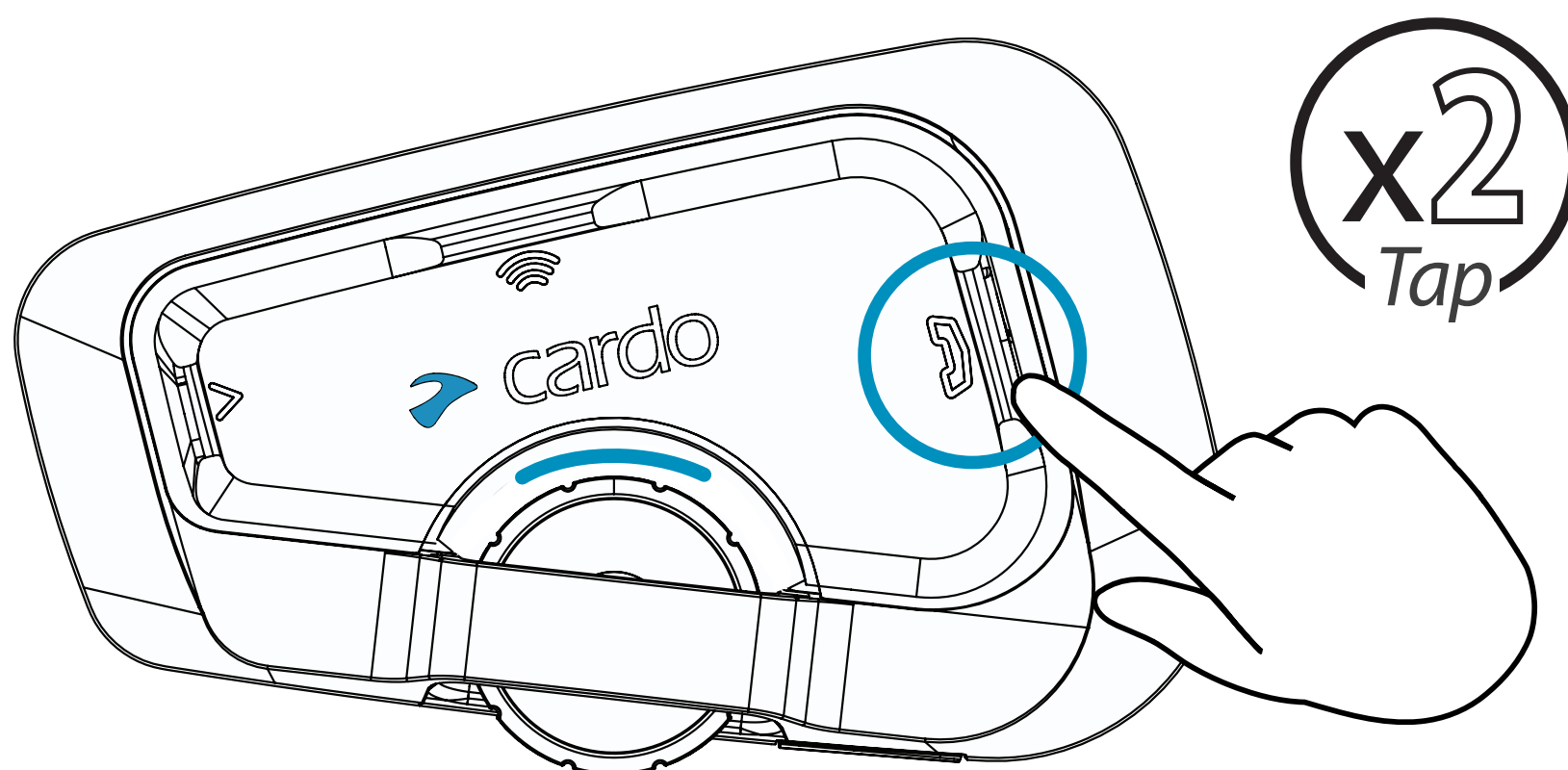

Intercomunicador Bluetooth



Emparejar

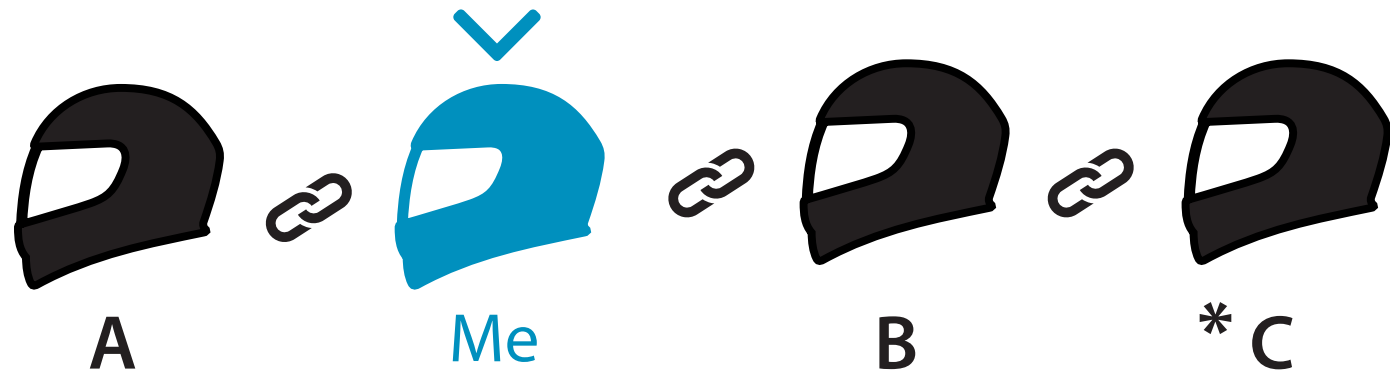

Emparejar con conductor A

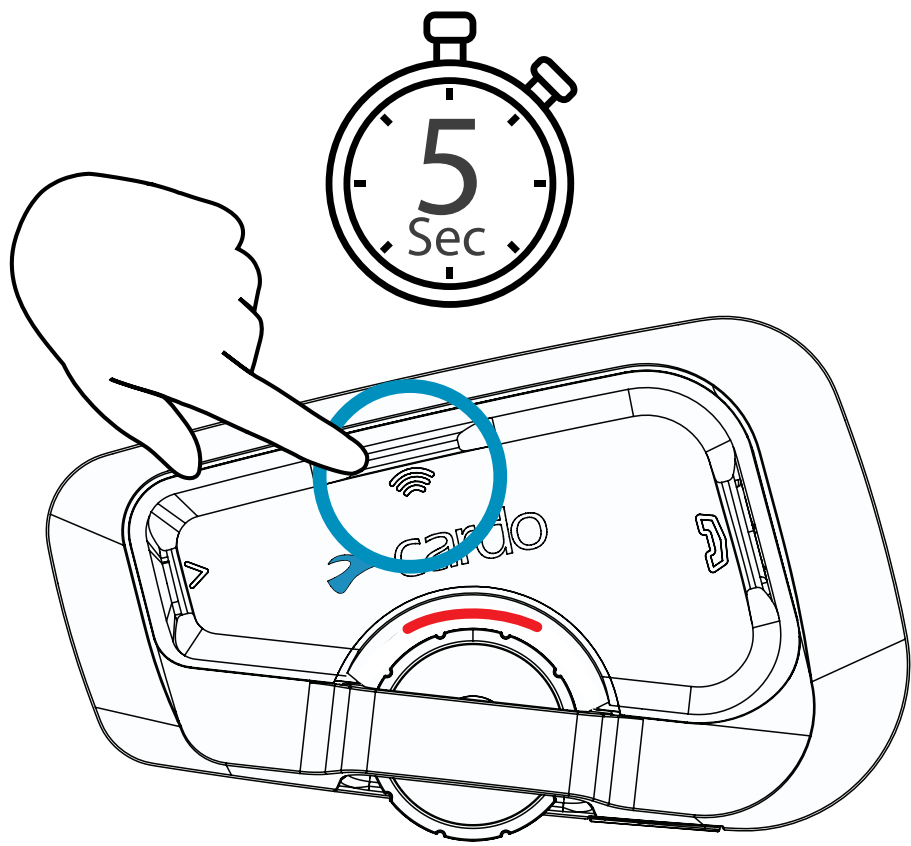

Emparejar con conductor B

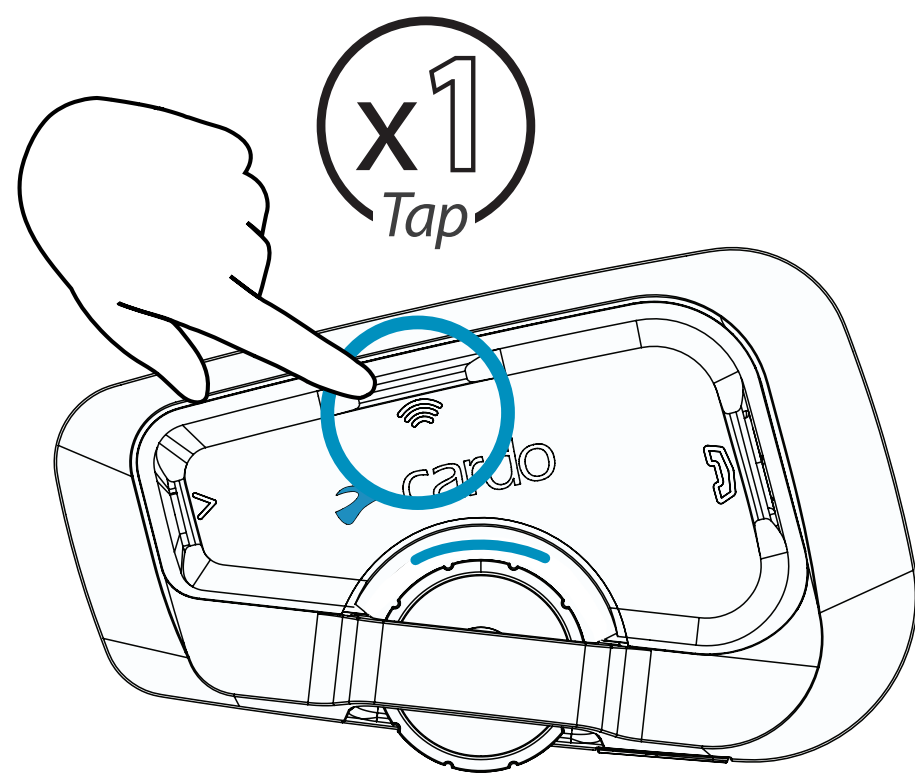
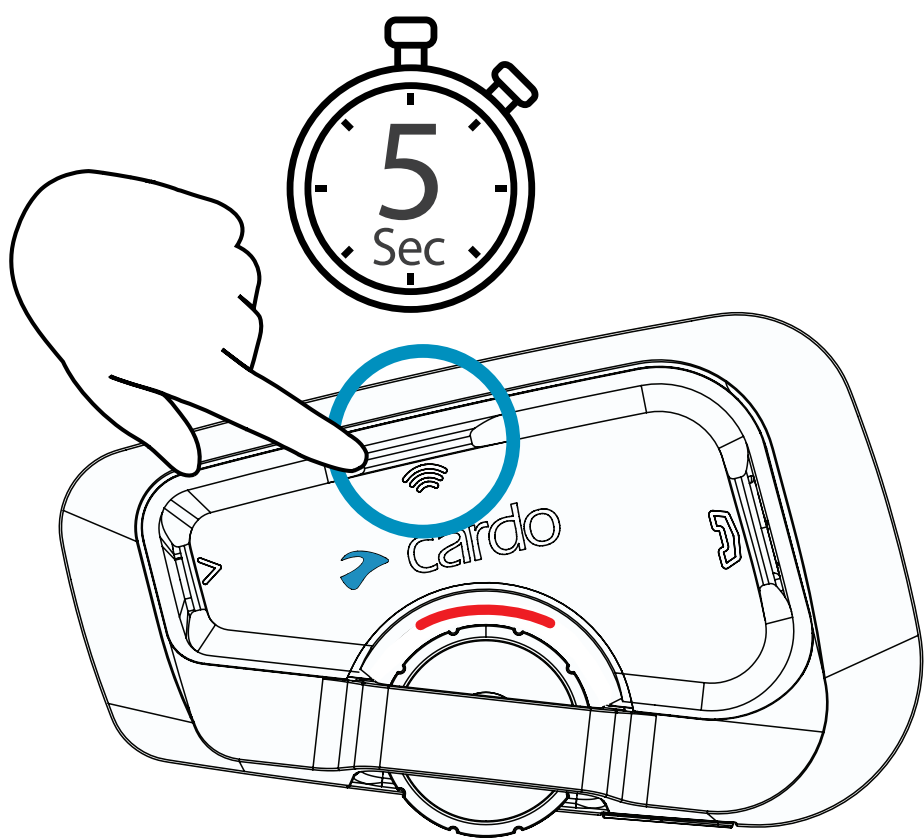

* El conductor C debe estar conectado al conductor B

Intercomunicador Bluetooth



Llamar/finalizar intercomunicación

Conductor A

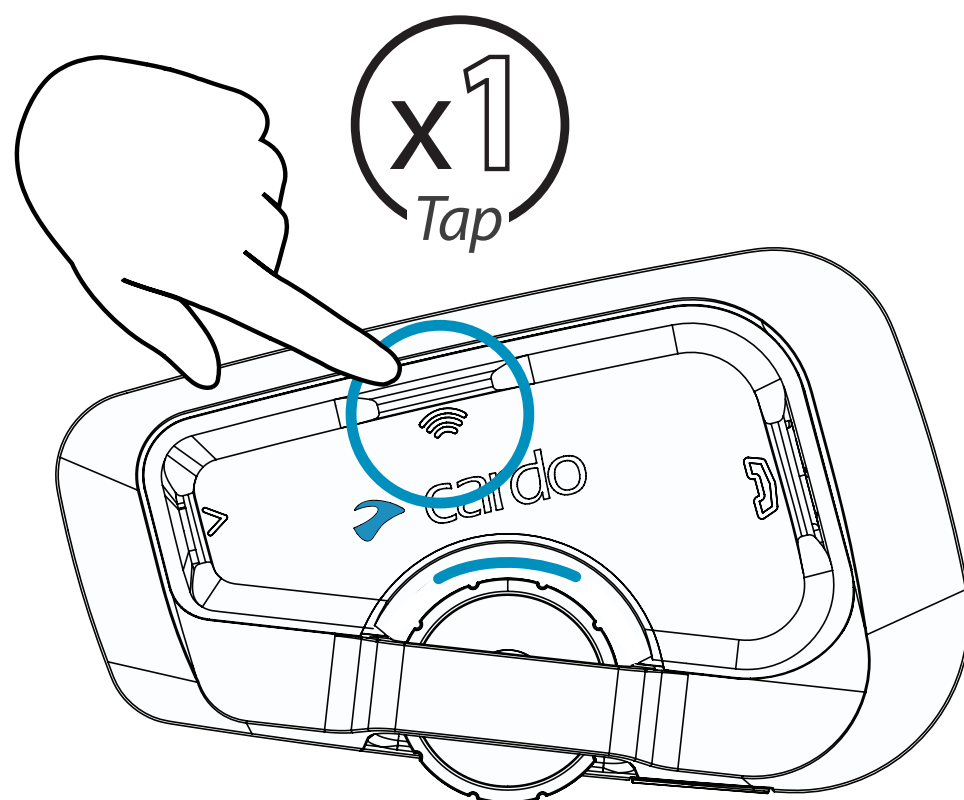

Conductor B

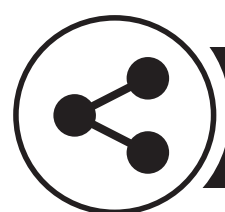
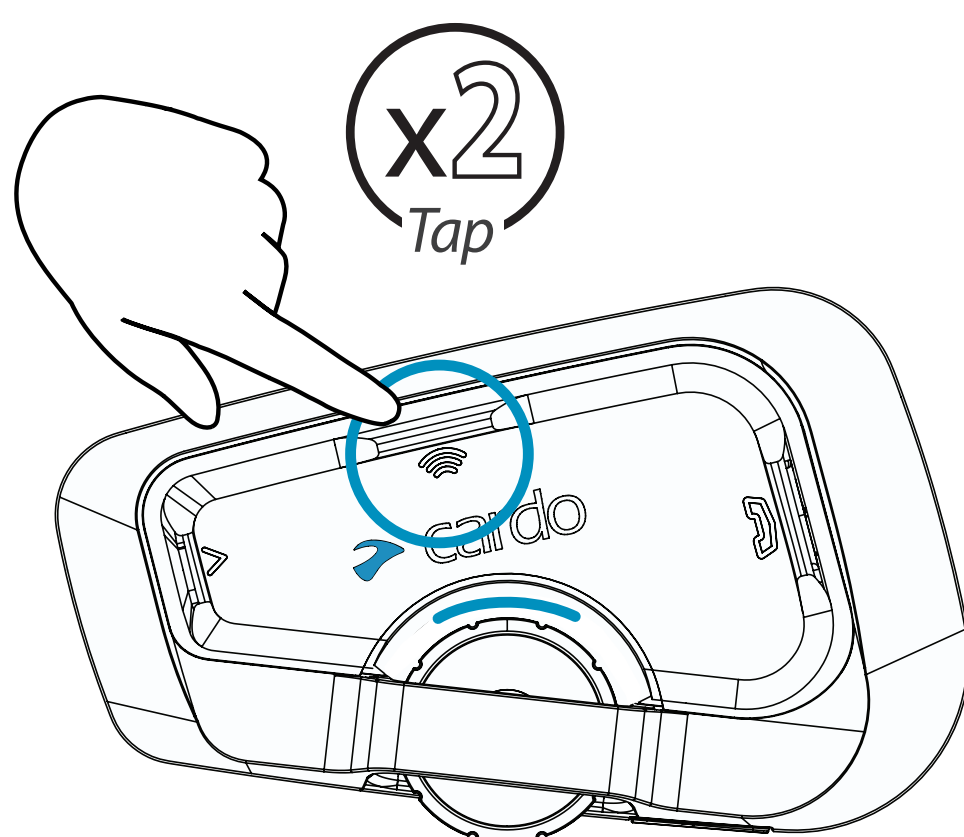

Compartir



Compartir música

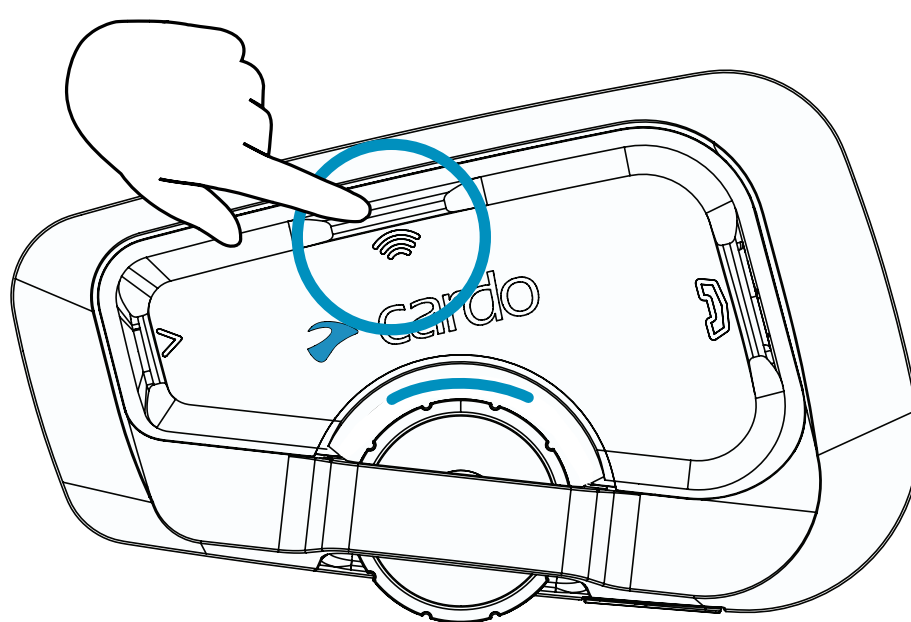

Compartir llamada telefónica

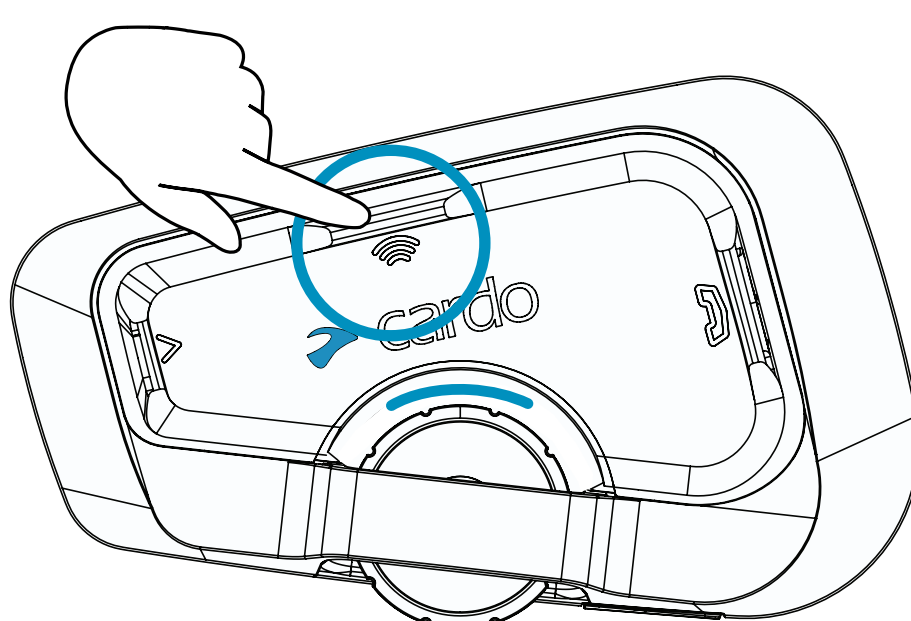
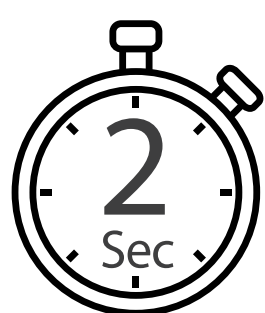

Emparejar con un GPS

1 Paso 1

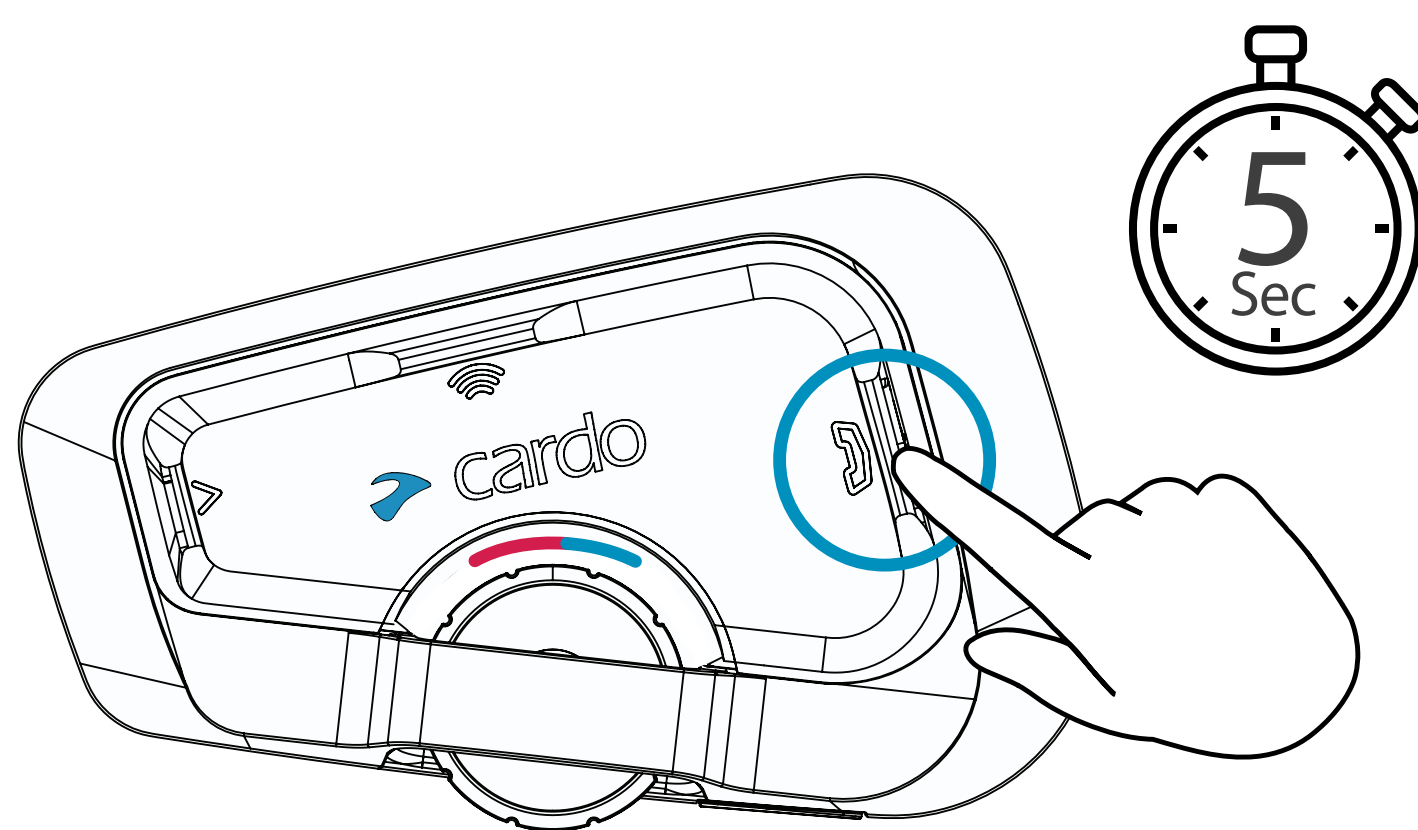

LED en rojo y azul



2 Paso 2

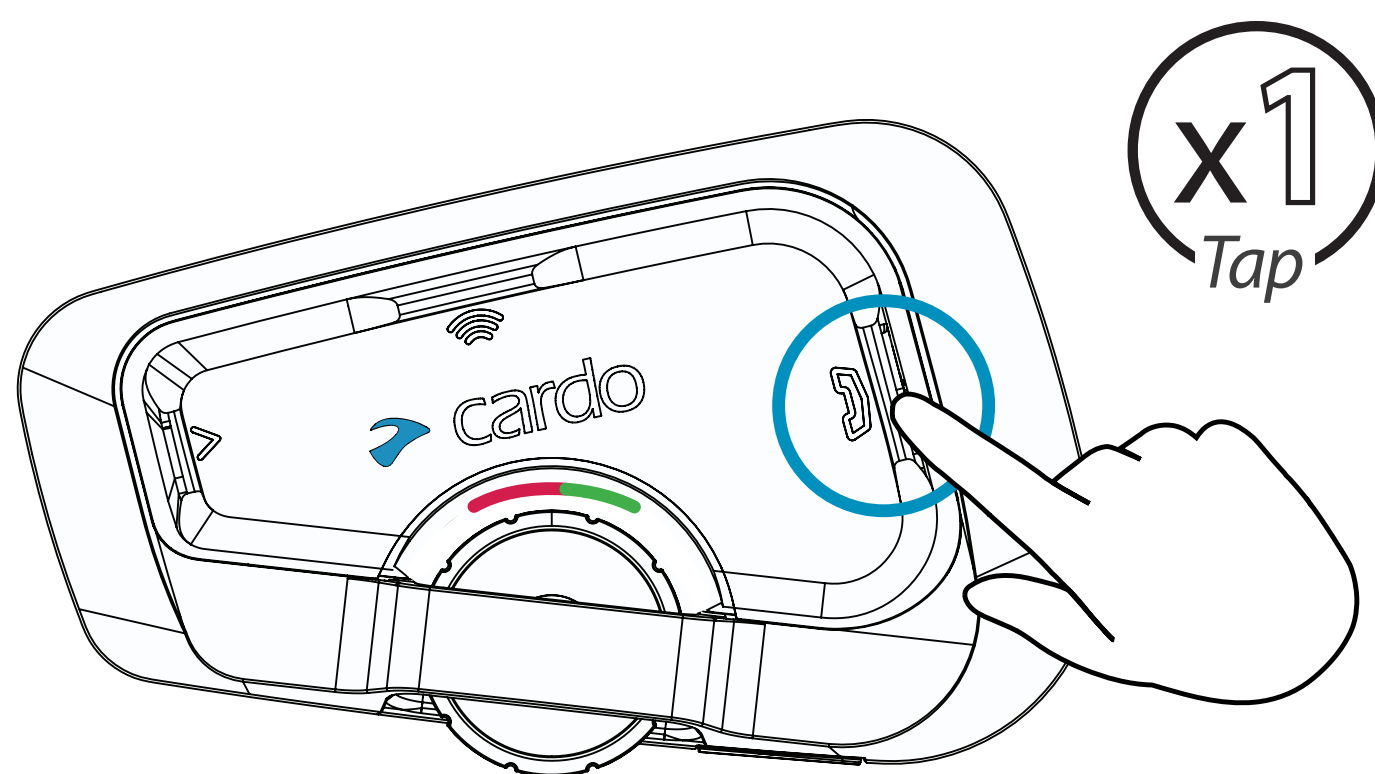

LED rojo y verde



3 Paso 3

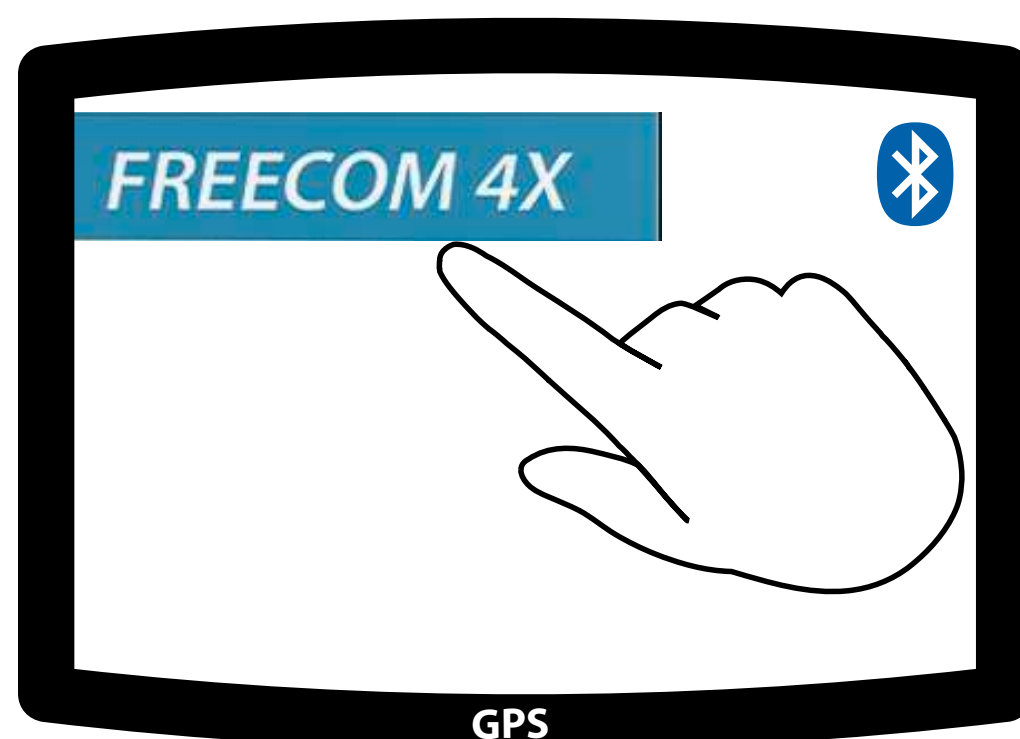

Comandos de voz: ¡siempre activados!



- **Contestar**
- **Ignorar**
- "Hey Cardo, **finaliza llamada**"
- "Hey Cardo, **marcación rápida**"
- "Hey Cardo, **remarcar número**"



- "Hey Cardo, **enciende la música**"
- "Hey Cardo, **apaga la música**"
- "Hey Cardo, **pista siguiente**"
- "Hey Cardo, **pista anterior**"
- "Hey Cardo, **comparte la música**"



- "Hey Cardo, **encender la radio**"
- "Hey Cardo, **apaga la radio**"
- "Hey Cardo, **estación siguiente**"
- "Hey Cardo, **estación anterior**"



- "Hey Cardo, **llam al Intercomunicador**"
- "Hey Cardo, **cierra el Intercomunicador**"



- "**Oye Siri**"
- "**Okay Google**"



- "Hey Cardo, **sube el volumen**"
- "Hey Cardo, **baja el volumen**"
- "Hey Cardo, **silenciar el audio**"
- "Hey Cardo, **reactivar el audio**"



- "Hey Cardo, **nivel de la batería**"

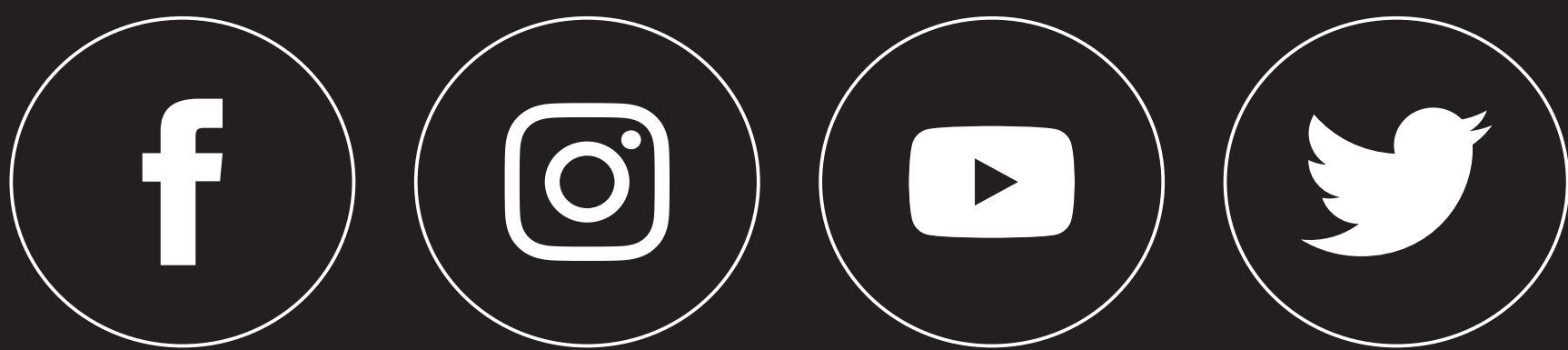

Cardosystems.com

Cardosystems.com/update

Cardosystems.com/support